



QUICK-FIT CONNECTORS AND SUCOFEED CABLES

Edition 2007/2008



FURTHER CATALOGUES OF RELATED PRODUCTS



Smart QUICK-FIT
(brochure)
Item no. 84028926

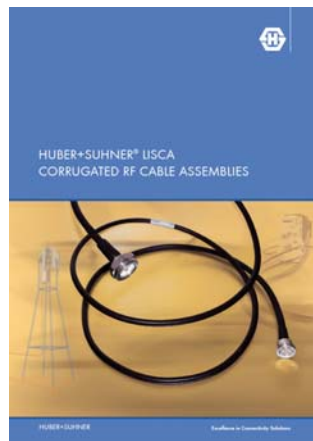

LISCA cable assemblies
(brochure)
Item no. 23035388



Lightning protectors
(product catalogue)
Item no. 23002023



Power splitters
(product catalogue)
Item no. 23041087



HUBER+SUHNER® QUICK-FIT COAXIAL CONNECTORS

DESCRIPTION

HUBER+SUHNER QUICK-FIT connectors are world-wide approved N and 7/16 connectors for foam dielectric corrugated copper tube cables. They offer a greatly simplified and economic approach to cable preparation and assembly. The product line meets the requirements of multi-carrier, high-channel-count transceivers such as base stations of today's mobile communication infrastructure networks.

The cable entries support standard foam dielectric corrugated copper tube cables 1/2", 7/8", 1 1/4" and 1 5/8" and 1/2" highflex SUCOFEED as well as equivalent products from Andrew, RFS (Kabelmetal) and NK-Cables.

CONTENTS

PAGE

| | |
|-----------------|----|
| Description | 1 |
| Features | 1 |
| Applications | 1 |
| Technical data | 2 |
| Series 7/16 | 5 |
| Series N | 8 |
| Tools | 12 |
| Accessories | 15 |
| SUCOFEED cables | 16 |

FEATURES

- **low, stable and reproducible PIM (Passive Intermodulation Product)**
 - typically -165 dBc
 - excellent performance under mechanical stress and severe environmental conditions
- **safe assembly process performance**
 - in-field termination with reproducible electrical performance
- **quick and easy assembly**
 - 2 main connector parts, 4 steps in less than 4 minutes
- **high IP rating**
 - IP 68
- **cable multi-brand compatibility**

APPLICATIONS

- **antenna links and internal connections of mobile phone base stations**
- **jumper cables and feeder lines**
- **Radio in the Local Loop (RLL) and WiMAX base stations**
- **in general radio transceivers with high requirements for low attenuation, PIM and VSWR**

TECHNICAL DATA

| ELECTRICAL DATA | REQUIREMENTS |
|--|---|
| Impedance | 50 Ω |
| Frequency range (for connector interface) | N: DC ... 11 GHz 7/16: DC ... 7.5 GHz |
| VSWR | ≤ 1.06 (RL ≥ 30 dB); $f \leq 2.5$ GHz |
| VSWR for types marked with (R) | ≤ 1.06 (RL ≥ 30 dB); $f \leq 2.0$ GHz |
| PIM ¹⁾ | better than -155 dBc |

¹⁾ Carrier to 3rd order intermodulation product ratio with 2 x 20 W (43 dBm) carrier power, $f \leq 1.88$ GHz

| MECHANICAL DATA | REQUIREMENTS |
|---|--|
| Recommended coupling nut torque IEC | N: 0.68 ... 1.13 Nm / 0.49 ... 0.82 ft lb. IEC 61169-16 7/16: 25 ... 30 Nm / 18.05 ... 21.66 ft lb. IEC 61169-4 |
| Recommended coupling nut torque HUBER+SUHNER | N: 3 Nm / 2.2 ft lb. with 100 matings max. |
| Coupling nut retention force | N: ≥ 450 N / 101.2 lbs. 7/16: ≥ 1000 N / 225.0 lbs. |
| Centre contact | captivated |
| Durability (matings) | ≥ 500 |

| ENVIRONMENTAL DATA | REQUIREMENTS |
|--------------------|--|
| Temperature range | - 40°C ... + 85°C / - 40 °F ... + 185 °F |
| IP rating | IP 68 (acc. to IEC 60529) |

| MATERIAL DATA | | |
|----------------|---------------|------------|
| CONNECTOR PART | MATERIAL | PLATING |
| Cable entry | brass | SUCOPLATE® |
| Connector head | brass | silver |
| Outer contact | brass | |
| Centre contact | spring bronze | |
| Insulators | PTFE or PFA | |
| Gaskets | rubber | |

Some connectors may have a specification that differs from the above mentioned data.

The products are designed and guaranteed to pass the above mentioned test procedures. Any additional or different requirement arising from specific applications or environmental conditions which is not covered by these test procedures is subject to request.

Design features to prevent Passive InterModulation (PIM)

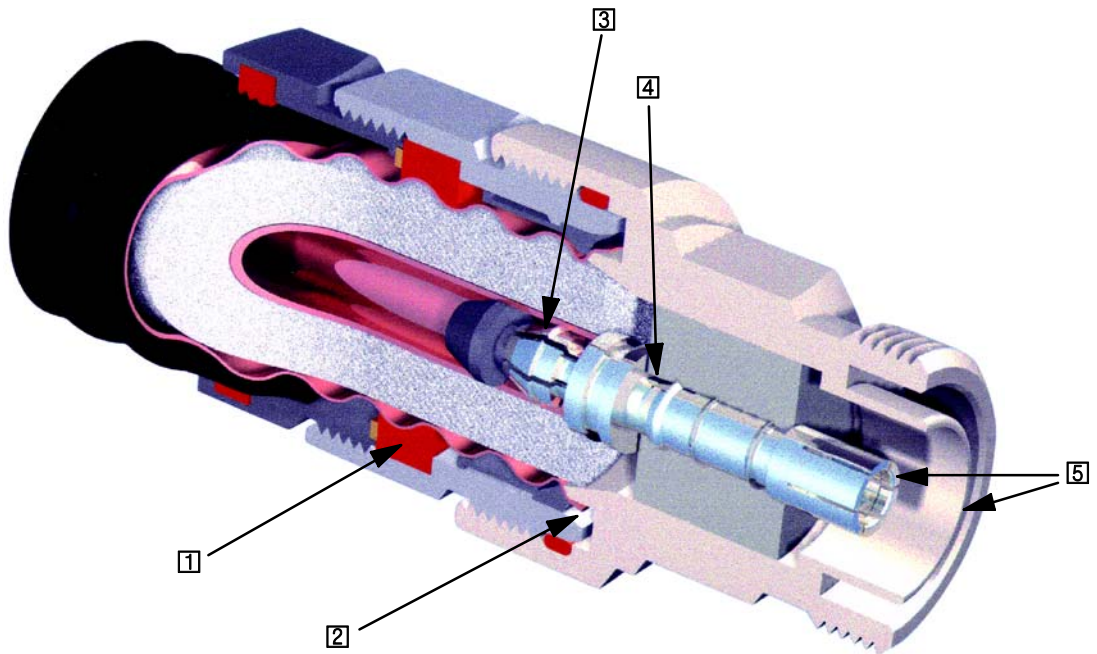

- 1 **Additional cable stabilization:** Compressable gaskets stabilize the cable inside the connector. This additional cable clamp prevents Passive InterModulation.
- 2 **Self-flaring outer contact:** The special geometry of the outer contact surface flares the outer conductor and guarantees a very high contact pressure.
- 3 **High contact force on spring fingers:** A special geometry of the spring fingers of the centre pin guarantees high contact forces.
- 4 **Stable and reliable contact force:** A flexible centre contact pin adjusts itself to its correct position even when the centre conductor is not centred or exposed to mechanical stress. A stable and reliable contact force on all contact fingers of the centre pin is thereby guaranteed.
- 5 **Silver-plated contact areas:** All contact areas are silver plated providing very low contact resistance and optimum Passive InterModulation performance.

Design features for guaranteed water protection

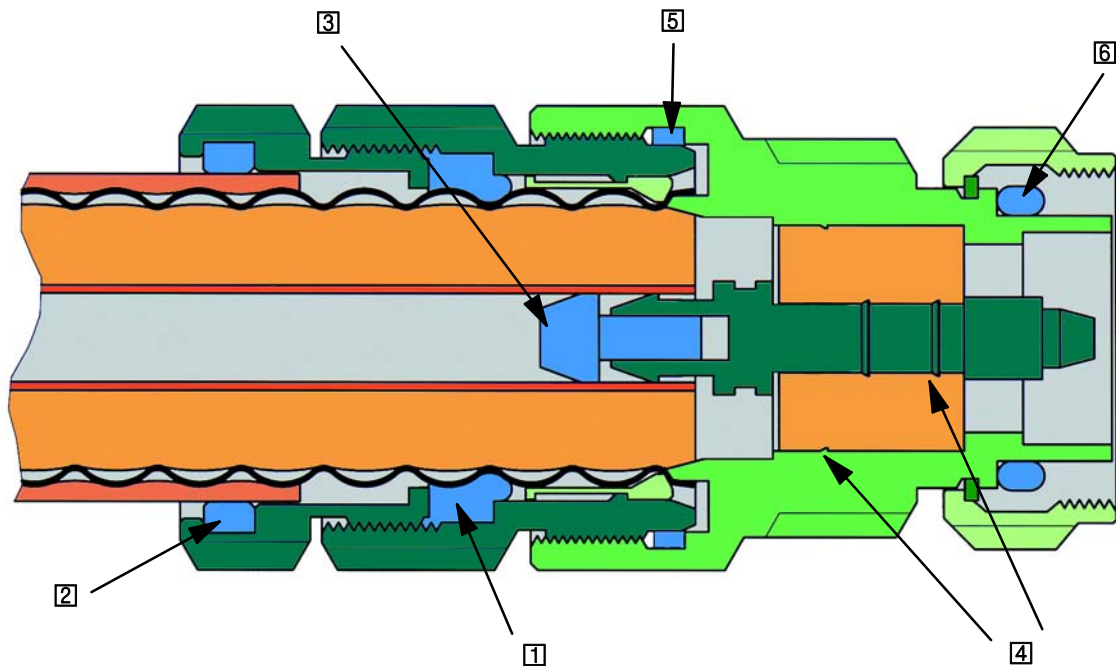

- | | | |
|-----|--|--|
| [1] | Sealing on the copper tube: | Compressible gasket seals on the outer conductor even when using cables of different manufacturers. It prevents water leakage even when the jacket is damaged. |
| [2] | Sealing on the jacket: | The special form of the gasket seals on the jacket in order to prevent water leakage on the jacket surface. |
| [3] | Sealing on the inner pin: | The refined design of the gasket guarantees that condensed water cannot leak into the connector. |
| [4] | Water barrier in the interface: | The special barbs on the centre and the outer conductor protect the interface against water leakage (additional security). |
| [5] | Sealing on the cable entry: | This O-ring prevents the water leakage on the cable entry. |
| [6] | Interface gasket: | The interface gasket prevents water leakage when the connector is mated. |

SERIES 7/16

Straight cable plugs (male)

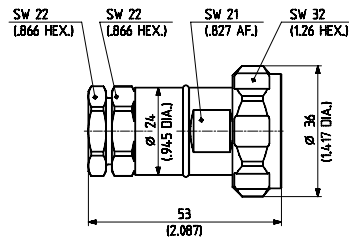

| HUBER+SUHNER type | Item no. | Cable group (example) | Packaging | Assembly instruction | Weight |
|---------------------|----------|-----------------------|-----------|----------------------|----------------|
| 11_716-50-9-9/003_E | 22660309 | M9 (SUCOFEED_1/2_HF) | single | 0000179418 | 126 g/4.41 oz. |

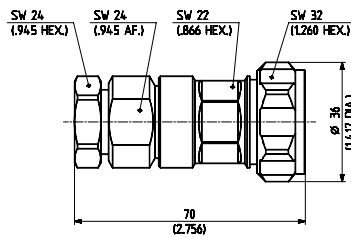

Fig. 1

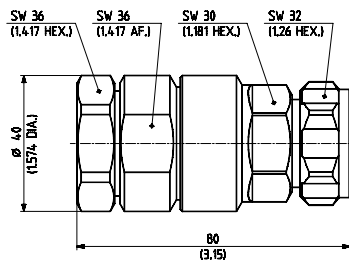

Fig. 2

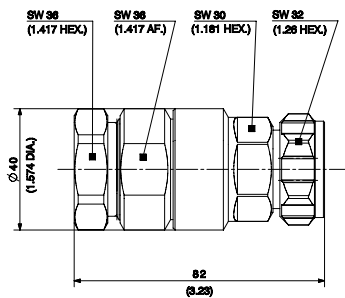

Fig. 3

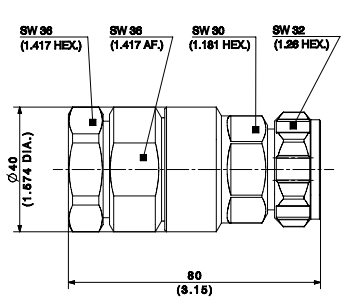

Fig. 4



| HUBER+SUHNER type | Item no. | Cable group (example) | Packaging | Assembly instruction | Weight | Fig. |
|-----------------------|----------|-----------------------|-----------|----------------------|----------------|------|
| 11_716-50-12-10/003_E | 22658311 | M12 (SUCOFEED_1/2) | single | 0000179113 | 169 g/5.92 oz. | 1 |
| 11_716-50-23-10/003_E | 23000309 | M23 (SUCOFEED_7/8) | single | 0000180164 | 327 g/11.4 oz. | 2 |
| 11_716-50-23-13/003_E | 84017916 | M25 (SUCOFEED_7/8_LA) | single | 0000243692 | 333 g/11.7 oz. | 3 |
| 11_716-50-23-14/003_E | 84018237 | M24 (SUCOFEED_7/8_HF) | single | 0000233737 | 333 g/11.7 oz. | 4 |

Straight cable plugs (male)

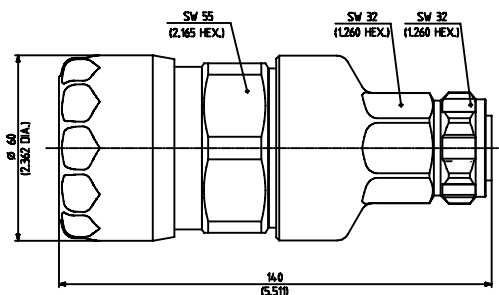

Fig. 1

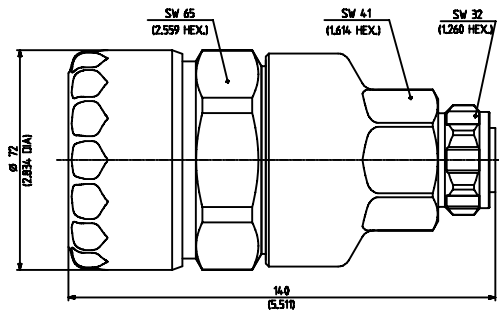

Fig. 2

| HUBER+SUHNER type | Item no. | Cable group (example) | Packaging | Assembly instruction | Weight | Fig. |
|----------------------|----------|-----------------------|-----------|----------------------|-----------------|-------|
| 11_716-50-32-2/003_Y | 22658187 | M32 (SUCOFEED_1_1/4) | single | 0000179128 | 1016 g/35.6 oz. | 1 (R) |
| 11_716-50-42-2/003_Y | 22658185 | M42 (SUCOFEED_1_5/8) | single | 0000179128 | 1298 g/45.4 oz. | 2 (R) |

(R) see VSWR on page 2

Right angle cable plugs (male)

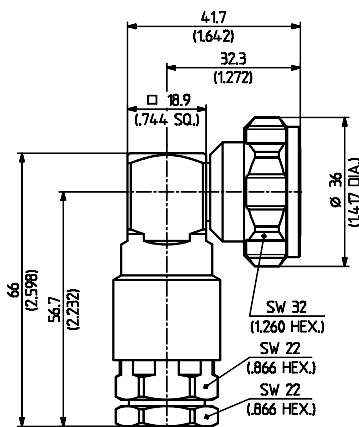

Fig. 1

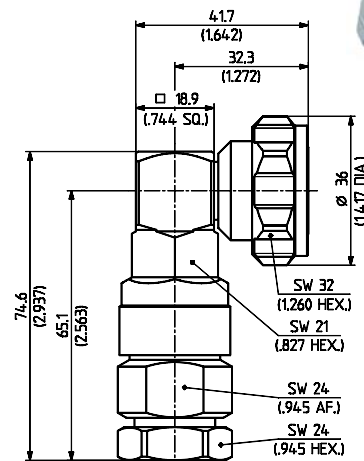
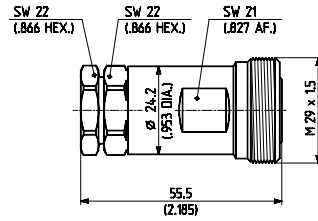

Fig. 2

| HUBER+SUHNER type | Item no. | Cable group (example) | Packaging | Assembly instruction | Weight | Fig. |
|-----------------------|----------|-----------------------|-----------|----------------------|----------------|------|
| 16_716-50-9-5/003_E | 23007298 | M9 (SUCOFEED_1/2_HF) | single | 0000179418 | 180 g/6.30 oz. | 1 |
| 16_716-50-12-11/003_E | 23011827 | M12 (SUCOFEED_1/2) | single | 0000179113 | 223 g/7.8 oz. | 2 |

Straight cable jacks (female)



| HUBER+SUHNER type | Item no. | Cable group (example) | Packaging | Assembly instruction | Weight |
|---------------------|----------|-----------------------|-----------|----------------------|----------------|
| 21_716-50-9-9/003_E | 23660310 | M9 (SUCOFEED_1/2_HF) | single | 0000179418 | 120 g/4.20 oz. |

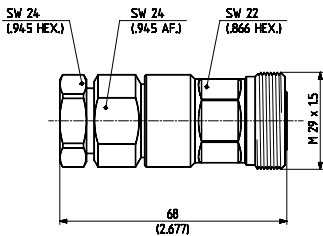

Fig. 1

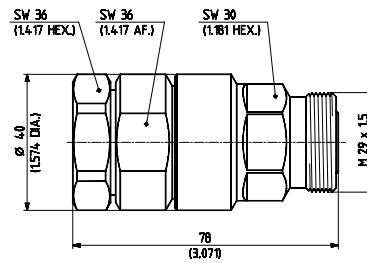

Fig. 2

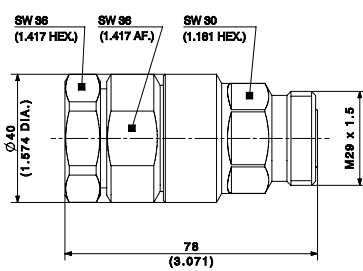

Fig. 3

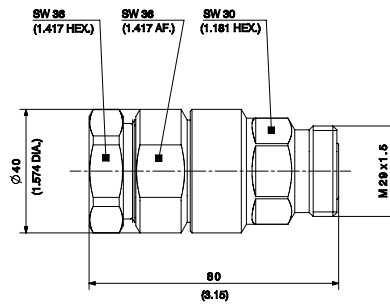

Fig. 4



| HUBER+SUHNER type | Item no. | Cable group (example) | Packaging | Assembly instruction | Weight | Fig. |
|-----------------------|----------|-----------------------|-----------|----------------------|----------------|------|
| 21_716-50-12-10/003_E | 22658313 | M12 (SUCOFEED_1/2) | single | 0000179113 | 153 g/5.36 oz. | 1 |
| 21_716-50-23-10/003_E | 23000310 | M23 (SUCOFEED_7/8) | single | 0000180164 | 315 g/11.0 oz. | 2 |
| 21_716-50-23-12/003_E | 84018251 | M24 (SUCOFEED_7/8_HF) | single | 0000233737 | 318 g/11.2 oz. | 3 |
| 21_716-50-23-13/003_E | 84022255 | M25 (SUCOFEED_7/8_LA) | single | 0000243692 | 318 g/11.2 oz. | 4 |

Straight cable jacks (female)

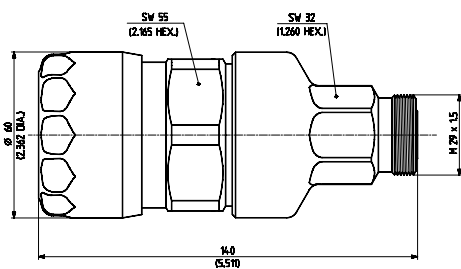

Fig. 1

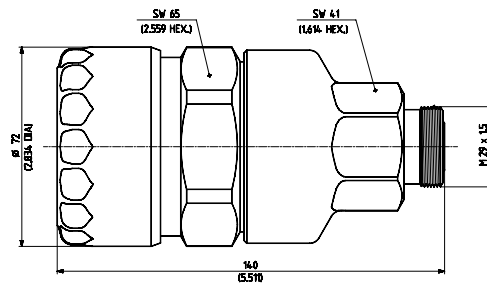

Fig. 2

| HUBER+SUHNER type | Item no. | Cable group (example) | Packaging | Assembly instruction | Weight | Fig. |
|----------------------|----------|-----------------------|-----------|----------------------|-----------------|-------|
| 21_716-50-32-2/003_Y | 22658188 | M32 (SUCOFEED_1_1/4) | single | 0000179128 | 1011 g/35.4 oz. | 1 (R) |
| 21_716-50-42-2/003_Y | 22658186 | M42 (SUCOFEED_1_5/8) | single | 0000179128 | 1291 g/45.2 oz. | 2 (R) |

(R) see VSWR on page 2

SERIES N

Straight cable plugs (male)

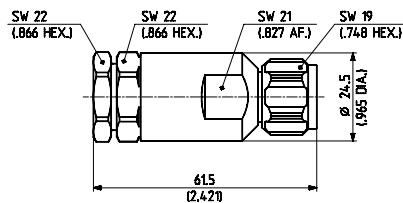

| HUBER+SUHNER type | Item no. | Cable group (example) | Packaging | Assembly instruction | Weight |
|-------------------|----------|-----------------------|-----------|----------------------|----------------|
| 11_N-50-9-9/003_E | 22660311 | M9 (SUCOFEED_1/2_HF) | single | 0000179418 | 112 g/3.92 oz. |

Straight cable plugs (male)

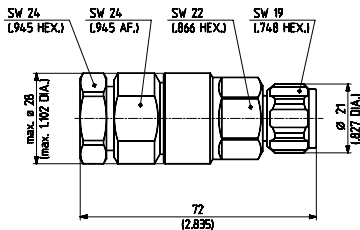

Fig. 1

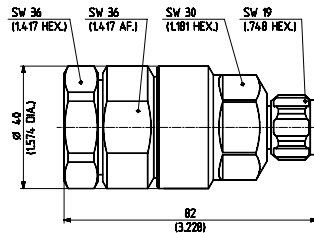

Fig. 2

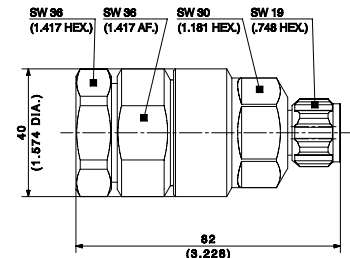

Fig. 3

| HUBER+SUHNER type | Item no. | Cable group (example) | Packaging | Assembly instruction | Weight | Fig. |
|---------------------|----------|-----------------------|-----------|----------------------|----------------|------|
| 11_N-50-12-10/003_E | 22658314 | M12 (SUCOFEED_1/2) | single | 0000179113 | 143 g/5.00 oz. | 1 |
| 11_N-50-23-10/003_E | 23000308 | M23 (SUCOFEED_7/8) | single | 0000180164 | 305 g/10.7 oz. | 2 |
| 11_N-50-23-11/003_E | 84018250 | M24 (SUCOFEED_7/8_HF) | single | 0000233737 | 312 g/11.0 oz. | 3 |

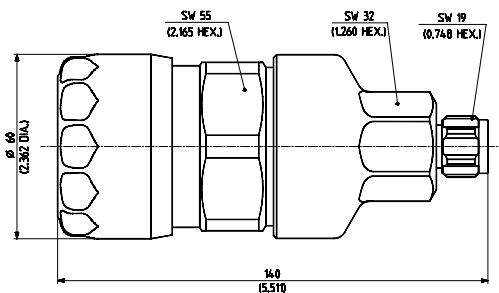

Fig. 1

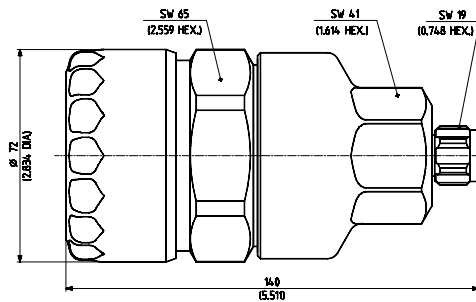

Fig. 2

| HUBER+SUHNER type | Item no. | Cable group (example) | Packaging | Assembly instruction | Weight | Fig. |
|--------------------|----------|-----------------------|-----------|----------------------|-----------------|-------|
| 11_N-50-32-2/003_Y | 22658189 | M32 (SUCOFEED_1_1/4) | single | 0000179128 | 990 g/34.7 oz. | 1 (R) |
| 11_N-50-42-2/003_Y | 22658191 | M42 (SUCOFEED_1_5/8) | single | 0000179128 | 1285 g/45.0 oz. | 2 (R) |

(R) see VSWR on page 2

Right angle cable plugs (male)

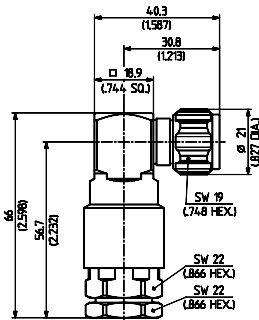

Fig. 1

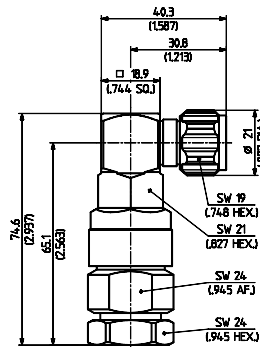
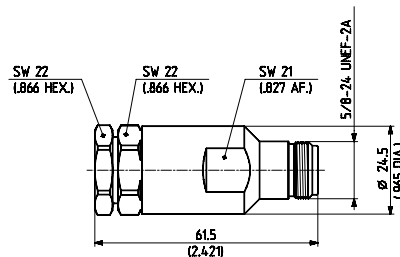

Fig. 2

| HUBER+SUHNER type | Item no. | Cable group (example) | Packaging | Assembly instruction | Weight | Fig. |
|--------------------|----------|-----------------------|-----------|----------------------|----------------|------|
| 16_N-50-9-6/003_E | 23007299 | M9 (SUCOFEED_1/2_HF) | single | 0000179418 | 164 g/5.75 oz. | 1 |
| 16_N-50-12-9/003_E | 23011828 | M12 (SUCOFEED_1/2) | single | 0000179113 | 208 g/7.30 oz. | 2 |

Straight cable jacks (female)



| HUBER+SUHNER type | Item no. | Cable group (example) | Packaging | Assembly instruction | Weight |
|-------------------|----------|-----------------------|-----------|----------------------|----------------|
| 21_N-50-9-9/003_E | 22660312 | M9 (SUCOFEED_1/2_HF) | single | 0000179418 | 113 g/3.96 oz. |

Straight cable jacks (female)

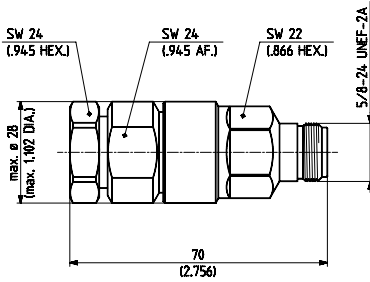

Fig. 1

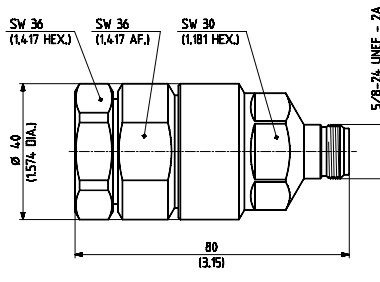

Fig. 2

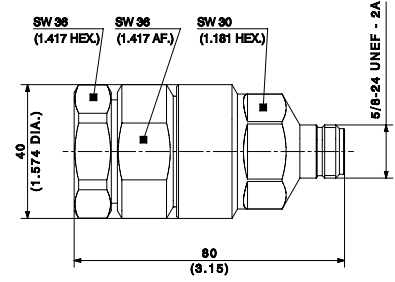

Fig. 3

| HUBER+SUHNER type | Item no. | Cable group (example) | Packaging | Assembly instruction | Weight | Fig. |
|---------------------|----------|-----------------------|-----------|----------------------|----------------|------|
| 21_N-50-12-10/003_E | 22658315 | M12 (SUCOFEED_1/2) | single | 0000179113 | 142 g/4.97 oz. | 1 |
| 21_N-50-23-10/003_E | 23000307 | M23 (SUCOFEED_7/8) | single | 0000180164 | 300 g/10.5 oz. | 2 |
| 21_N-50-23-11/003_E | 84018249 | M24 (SUCOFEED_7/8_HF) | single | 0000233737 | 313 g/11.0 oz. | 3 |

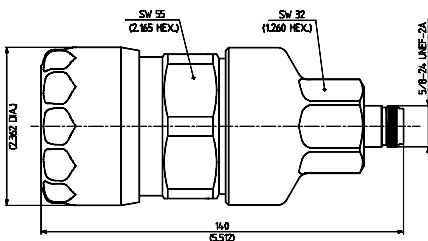

Fig. 1

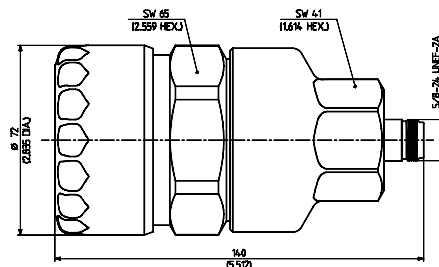

Fig. 2

| HUBER+SUHNER type | Item no. | Cable group (example) | Packaging | Assembly instruction | Weight | Fig. |
|--------------------|----------|-----------------------|-----------|----------------------|-----------------|-------|
| 21_N-50-32-2/003_Y | 22658190 | M32 (SUCOFEED_1_1/4) | single | 0000179128 | 989 g/34.6 oz. | 1 (R) |
| 21_N-50-42-2/003_Y | 22658192 | M42 (SUCOFEED_1_5/8) | single | 0000179128 | 1279 g/44.8 oz. | 2 (R) |

(R) see VSWR on page 2

TOOLS FOR HUBER+SUHNER QUICK-FIT CONNECTORS

Cable stripping tools for easy cable preparation
in one single operation
(can be used manually or with electrical power tool)



| H+S type | Item no. | Cable type | Assembly instructions |
|--------------|----------|--|--------------------------------------|
| 74_Z-0-8-15 | 23000296 | 3/8": Andrew LDF 2-50 | 0000180713 |
| 74_Z-0-9-15 | 23001006 | 1/2" Highflex: SUCOFEED®, Andrew, NK cables, RFS (Kabelmetal) | 0000179418/ 0000201603 |
| 74_Z-0-12-15 | 23000319 | 1/2": SUCOFEED®, Andrew, NK cables, RFS (Kabelmetal) | 0000179113 |
| 74_Z-0-23-16 | 23007928 | 7/8": SUCOFEED®, Andrew, NK cables, RFS (Kabelmetal) 7/8" Highflex: SUCOFEED®, Andrew | 0000180164/ 0000201645 0000233737 |
| 74_Z-0-23-17 | 84017918 | 7/8" Low attenuation: SUCOFEED®, Andrew | 0000243692/0000236366 |
| 74_Z-0-32-14 | 23010533 | 1 1/4": SUCOFEED®, Andrew, NK cables, RFS (Kabelmetal) | 0000179128 |
| 74_Z-0-42-14 | 23010534 | 1 5/8": SUCOFEED®, Andrew, NK cables, RFS (Kabelmetal) | 0000179128 |

HUBER+SUHNER QUICK-FIT installation kit

Tool kit for all QUICK-FIT Connectors
(with additional space for other auxiliary tools and spare parts)

Important:
Stripping tools can be accommodated but are not included



| H+S type | Item no. | Description | Content | Size |
|--------------|----------|-------------|--|--|
| 74_Z-0-0-600 | 23002174 | tool box | all tools of the following table marked with * | 620 × 430 × 140 mm/ 24.4 × 17 × 1.5 in. |

Overview necessary tools for the assembly of QUICK-FIT connectors

| H+S type | Item no. | Part description | Corrugated copper tube cables | | | | | | | 1 1/4" | 1 5/8" |
|--------------|----------|---|-------------------------------|-----------------|-----------------|-----------------|-----------------|-----------------|-----------------|-----------------|-----------------|
| | | | 3/8" LFD 2-50 | 1/2" HF | 1/2" | 7/8" | 7/8" HF | 7/8" LA | | | |
| 74_Z-0-8-15 | 23000296 | stripping tool (3/8" LFD 2-50) | X | | | | | | | | |
| 74_Z-0-9-15 | 23001006 | stripping tool (1/2" HF) | | X | | | | | | | |
| 74_Z-0-12-15 | 23000319 | stripping tool (1/2") | | | X | | | | | | |
| 74_Z-0-23-16 | 23007928 | stripping tool (7/8" + 7/8" HF) | | | | optional | optional | | | | |
| 74_Z-0-23-17 | 84017918 | stripping tool (7/8" LA) | | | | | | optional | | | |
| 74_Z-0-32-14 | 23010533 | stripping tool (1_1/4") | | | | | | | optional | | |
| 74_Z-0-42-14 | 23010534 | stripping tool (1_5/8") | | | | | | | | | optional |
| 74_Z-0-0-359 | 23014976 | handle (for stripping tools) | X ⁴⁾ | X ⁴⁾ | X ⁴⁾ | optional | optional | optional | optional | optional | optional |
| 74_Z-0-0-402 | 22652193 | * abrasive paper 320 | X | X | X | | | | | | |
| 74_Z-0-0-424 | 23001952 | * spanner AF 17 mm | X | | | | | | | | |
| 74_Z-0-0-425 | 23001953 | * spanner AF 18 mm | X | | | | | | | | |
| 74_Z-0-0-426 | 23001954 | * spanner AF 19 mm | X | | | | | | | | |
| 74_Z-0-0-427 | 23001955 | * spanner AF 21 mm | X | X | | | | | | | |
| 74_Z-0-0-428 | 23001956 | * spanner AF 22 mm | | X | X | | | | | | |
| 74_Z-0-0-429 | 23001957 | * spanner AF 24 mm | | | X | | | | | | |
| 74_Z-0-0-430 | 23001958 | * spanner AF 30 mm | | | | X | X | X | | | |
| 74_Z-0-0-431 | 23001959 | * spanner AF 36 mm | | | | X | X | X | | | |
| 74_Z-0-0-415 | 22652206 | * counter sink | | | | X ¹⁾ | X ¹⁾ | X ¹⁾ | X ¹⁾ | X ¹⁾ | X ¹⁾ |
| 74_Z-0-0-418 | 22652209 | * Stanley knife | X | X | X | X | X | X | X | X | X |
| 74_Z-0-0-420 | 22652211 | * steel brush | | | X | X | X | X | X | X | X |
| 74_Z-0-0-422 | 22652213 | * steel measure 200 mm | X ²⁾ | X ²⁾ | X ²⁾ | X ²⁾ | X ²⁾ | X ²⁾ | X ²⁾ | X ²⁾ | X ²⁾ |
| 74_Z-0-0-432 | 23002005 | * screw driver (2) | X | | X | | | | | | |
| 74_Z-0-0-433 | 23002007 | * screw driver (4) | | | | X | X | X | X | X | X |
| 74_Z-0-0-12 | 22642718 | small metal saw | X | X | X | X | X | X | X | X | X |
| 74_Z-0-0-434 | 23002166 | monkey wrench ³⁾ (min.65mm) | | | | | | | | X | X |
| | | small file | X ²⁾ | X ²⁾ | X ²⁾ | | | | | | |

* = tools included in the HUBER+SUHNER QUICK-FIT installation kit 74_Z-0-0-600, (can be ordered with item no. 23002174)

- 1) for assembly use either the Stanley knife or the counter sink
- 2) only necessary without HUBER+SUHNER stripping tool
- 3) 2 wrenches are needed for assembling
- 4) handle included in QUICK-FIT stripping tool delivery

Spare parts for QUICK-FIT cable stripping tools



| H+S type | Item no. | Description | Application | Function |
|--------------|----------|----------------|---|---|
| 74_Z-0-0-346 | 23000936 | blade | 74_Z-0-8-15 74_Z-0-8-16 74_Z-0-9-15 74_Z-0-12-15 | stripping jacket |
| 74_Z-0-0-347 | 23000937 | blade | 74_Z-0-8-15 74_Z-0-8-16 74_Z-0-12-15 | cutting corrugated copper tube |
| 74_Z-0-0-348 | 23000938 | triangle knife | 74_Z-0-8-15 74_Z-0-8-16 74_Z-0-9-15 74_Z-0-12-15 | deburring inner conductor |
| 74_Z-0-0-349 | 23001008 | blade | 74_Z-0-9-15 | cutting corrugated copper tube |
| 74_Z-0-0-297 | 22650531 | blade | 74_Z-0-23-16 74_Z-0-23-17 | cutting corrugated copper, foam and inner conductor |
| 74_Z-0-0-355 | 23008264 | blade | 74_Z-0-23-16 74_Z-0-32-14 74_Z-0-32-17 | stripping jacket |
| 74_Z-0-0-356 | 23010537 | blade | 74_Z-0-42-14 | stripping jacket |

Additional tools for HUBER+SUHNER QUICK-FIT cable stripping tools

| H+S type | Item no. | Tool description | Function |
|--------------|----------|-----------------------------------|--|
| 74_Z-0-0-416 | 22652207 | * allen wrench AF 2.5 mm/.098 in. | spare blades for the stripping tools 74_Z-0-8-15, 74_Z-0-8-16, 74_Z-0-9-15, 74_Z-0-12-15, 74_Z-0-23-16, 74_Z-0-23-17, 74_Z-0-32-14 and 74_Z-0-42-14 |
| 74_Z-0-0-423 | 23000311 | * allen wrench AF 4 mm/.157 in. | for removing the BIT adaptor |
| 74_Z-0-0-421 | 22652212 | * screwdriver, Torx 1 (Torx T7) | for changing the triangle knife 74_Z-0-0-348 |

* = not included in the HUBER+SUHNER QUICK-FIT installation kit 74_Z-0-0-600

ACCESSORIES

Cold shrink tubes for additional protection



| H+S type | Item no. | Packaging | Application of connector pair |
|-----------------|----------|-----------------|--|
| 73_Z-0-0-337/-Z | 22658883 | bulk 10 pcs. | 3/8" - 1/2" 3/8" EFX - 1/2" 1/2" HF - 1/2" HF 1/2" HF - 1/2" 1/2" - 1/2" |
| 73_Z-0-0-338/-Z | 22658884 | bulk 10 pcs. | 1/2" HF - 7/8" 1/2" - 7/8" 7/8" - 7/8" |
| 73_Z-0-0-339/-Y | 22658885 | bulk (variable) | 1/2" HF - 1 1/4" 1/2" HF - 1 5/8" 1/2" - 1 1/4" 1/2" - 1 5/8" 7/8" - 1 1/4" 7/8" - 1 5/8" |
| 73_Z-0-0-340/-Y | 22658886 | bulk (variable) | 1 1/4" - 1 1/4" 1 1/4" - 1 5/8" 1 5/8" - 1 5/8" |

Example:



HUBER+SUHNER SUCOFEED CORRUGATED COAXIAL CABLES



| Cable design | SUCOFEEED_1/4_HF | | SUCOFEEED_1/4_HF_FR | | SUCOFEEED_3/8_HF | | SUCOFEEED_3/8_HF_FR | | SUCOFEEED_3/8_HF_FR_UL | |
|-----------------------------|------------------|----------------|---------------------|-----------------|------------------|----------------|---------------------|-----------------|----------------------------------|----------------------------------|
| | Dimension | 1/4" high-flex | 1/4" high-flex | 1/4" high-flex | 3/8" high-flex | 3/8" high-flex | 3/8" high-flex | 3/8" high-flex | 3/8" high-flex | 3/8" high-flex |
| Cable group | M5 | M5 | M5 | M5 | M7 | M7 | M7 | M7 | M7 | M7 |
| Jacket version | standard | standard | flame retardant | flame retardant | standard | standard | flame retardant | flame retardant | high flame retardant / UL-listed | high flame retardant / UL-listed |
| Inner conductor | (∅ in mm) | 1.90 | 1.90 | 1.90 | 2.80 | 2.80 | 2.80 | 2.80 | 2.80 | 2.80 |
| Dielectric | (∅ in mm) | 4.60 | 4.60 | 4.40 | 7.00 | 7.00 | 7.00 | 7.00 | 7.00 | 6.90 |
| Outer conductor | (∅ in mm) | 6.40 | 6.40 | 6.40 | 9.50 | 9.50 | 9.50 | 9.50 | 9.50 | 9.50 |
| Jacket | (∅ in mm) | 7.60 | 7.60 | 7.95 | 10.80 | 10.80 | 10.80 | 10.80 | 10.80 | 11.15 |
| Electrical data | | | | | | | | | | |
| Typ. operating frequency | (GHz) | ≤ 18 | ≤ 18 | ≤ 18 | ≤ 12 | ≤ 12 | ≤ 12 | ≤ 12 | ≤ 12 | ≤ 12 |
| Impedance | (Ω) | 50 ± 1 | 50 ± 1 | 50 ± 1 | 50 ± 1 | 50 ± 1 | 50 ± 1 | 50 ± 1 | 50 ± 1 | 50 ± 1 |
| Capacitance | (pF/m) | 79.7 | 79.7 | 80 | 79.9 | 79.9 | 79.9 | 79.9 | 79.9 | 80 |
| Relative signal propagation | (%) | 83.5 | 83.5 | 83 | 83 | 83 | 83 | 83 | 83 | 83 |
| Signal delay | (ns/m) | 4.00 | 4.00 | 4.00 | 4.00 | 4.00 | 4.00 | 4.00 | 4.00 | 4.00 |
| Max. operating voltage | (kVrms) | 0.6 | 0.6 | 0.6 | 0.9 | 0.9 | 0.9 | 0.9 | 0.9 | 0.9 |
| Typ. attenuation @ 1 GHz | (dB/100m) | 19.54 | 19.54 | 19.56 | 13.33 | 13.33 | 13.33 | 13.33 | 13.33 | 13.33 |
| Typ. attenuation @ 2 GHz | (dB/100m) | 28.45 | 28.45 | 28.53 | 19.43 | 19.43 | 19.43 | 19.43 | 19.43 | 19.43 |
| Typ. attenuation @ 2.2 GHz | (dB/100m) | 29.98 | 29.98 | 30.08 | 20.48 | 20.48 | 20.48 | 20.48 | 20.48 | 20.48 |
| Max. power @ 1 GHz (40°C) | (kW) | ≤ 0.290 | ≤ 0.290 | ≤ 0.290 | ≤ 0.540 | ≤ 0.540 | ≤ 0.540 | ≤ 0.540 | ≤ 0.540 | ≤ 0.540 |
| Max. power @ 2 GHz (40°C) | (kW) | ≤ 0.205 | ≤ 0.205 | ≤ 0.205 | ≤ 0.382 | ≤ 0.382 | ≤ 0.382 | ≤ 0.382 | ≤ 0.382 | ≤ 0.382 |
| Max. power @ 2.2 GHz (40°C) | (kW) | ≤ 0.196 | ≤ 0.196 | ≤ 0.196 | ≤ 0.364 | ≤ 0.364 | ≤ 0.364 | ≤ 0.364 | ≤ 0.364 | ≤ 0.364 |
| General data | | | | | | | | | | |
| Temp. range operating | (°C) | -40 / +85 | -40 / +85 | -40 / +85 | -40 / +85 | -40 / +85 | -40 / +85 | -40 / +85 | -40 / +85 | -40 / +85 |
| Temp. range installation | (°C) | 10.0 | 10.0 | 8.7 | 13.0 | 13.0 | 13.0 | 13.0 | 13.0 | 14.2 |
| Typ. weight | (kg/100m) | 10.0 | 10.0 | 8.7 | 14.3 | 14.3 | 14.3 | 14.3 | 14.3 | 14.2 |
| Min. bending radius | (mm) | 25 | 25 | 25 | 25 | 25 | 25 | 25 | 25 | 25 |

For detailed data sheets please go to www.hubersuhner.com and then search for type "SUCOFEEED".

HUBER+SUHNER SUCOFEED CORRUGATED COAXIAL CABLES



| | SUCOFEEED_1/2_HF | | SUCOFEEED_1/2_HF_FR | | SUCOFEEED_1/2_HF_FR_UL | | SUCOFEEED_1/2_FR | | SUCOFEEED_1/2_FR_UL | |
|-----------------------------|------------------|----|---------------------|----|----------------------------------|----|------------------|-----|----------------------------------|-----|
| | 1/2" High-flex | M9 | 1/2" High-flex | M9 | 1/2" High-flex | M9 | 1/2" High-flex | M12 | 1/2" High-flex | M12 |
| Cable design | Standard | | Flame retardant | | High flame retardant / UL-listed | | Flame retardant | | High flame retardant / UL-listed | |
| Inner conductor | 3.60 | | 3.60 | | 3.60 | | 4.80 | | 4.80 | |
| Dielectric | 8.80 | | 8.80 | | 8.70 | | 12.10 | | 11.90 | |
| Outer conductor | 12.20 | | 12.20 | | 12.10 | | 13.80 | | 13.70 | |
| Jacket | 13.40 | | 13.40 | | 13.65 | | 15.90 | | 16.00 | |
| Electrical data | | | | | | | | | | |
| Typ. operating frequency | ≤ 10 | | ≤ 10 | | ≤ 10 | | ≤ 8 | | ≤ 8 | |
| Impedance | 50 ± 1 | | 50 ± 1 | | 50 ± 1 | | 50 ± 1 | | 50 ± 1 | |
| Capacitance | 80.3 | | 80.3 | | 78.5 | | 75.9 | | 76 | |
| Relative signal propagation | 83 | | 83 | | 85 | | 88 | | 88 | |
| Signal delay | 4.00 | | 4.00 | | 3.90 | | 3.80 | | 3.80 | |
| Max. operating voltage | 1.27 | | 1.27 | | 1.27 | | 1.60 | | 1.60 | |
| Typ. attenuation @ 1 GHz | 10.67 | | 10.67 | | 10.67 | | 7.29 | | 7.29 | |
| Typ. attenuation @ 2 GHz | 15.69 | | 15.69 | | 15.69 | | 10.62 | | 10.62 | |
| Typ. attenuation @ 2.2 GHz | 16.56 | | 16.56 | | 16.56 | | 11.20 | | 11.20 | |
| Max. power @ 1 GHz (40°C) | ≤ 0.780 | | ≤ 0.780 | | ≤ 1.040 | | ≤ 1.040 | | ≤ 1.180 | |
| Max. power @ 2 GHz (40°C) | ≤ 0.552 | | ≤ 0.552 | | ≤ 0.735 | | ≤ 0.735 | | ≤ 0.834 | |
| Max. power @ 2.2 GHz (40°C) | ≤ 0.526 | | ≤ 0.526 | | ≤ 0.701 | | ≤ 0.701 | | ≤ 0.796 | |
| General data | | | | | | | | | | |
| Temp. range operating | -40 / +85 | | -30 / +80 | | -40 / +85 | | -40 / +85 | | -40 / +85 | |
| Temp. range installation | -25 / +60 | | -25 / +60 | | -25 / +60 | | -25 / +60 | | -25 / +60 | |
| Typ. weight | 22.7 | | 24.0 | | 23.0 | | 25.0 | | 27.6 | |
| Min. bending radius | 25 | | 25 | | 25 | | 70 | | 70 | |

For detailed data sheets please go to www.hubersuhner.com and then search for type "SUCOFEEED".

HUBER+SUHNER SUCOFEED CORRUGATED COAXIAL CABLES



| | SUCOFEEED_7/8 | | SUCOFEEED_7/8_FR | | SUCOFEEED_7/8_HF | | SUCOFEEED_7/8_LA | |
|-----------------------------|---------------|-----------|------------------|-----|------------------|-----|----------------------|-----------|
| | 7/8" | M23 | 7/8" | M23 | 7/8" high-flex | M24 | 7/8" low attenuation | M25 |
| Dimension | Standard | | Flame retardant | | Standard | | Standard | |
| Cable design | | | | | | | | |
| Inner conductor | ∅ in mm | 9.00 | | | | | | |
| Dielectric | ∅ in mm | 22.30 | | | | | | |
| Outer conductor | ∅ in mm | 24.80 | | | | | | |
| Jacket | ∅ in mm | 27.60 | | | | | | |
| Electrical data | | | | | | | | |
| Typ. operating frequency | (GHz) | ≤ 5 | | | | | | ≤ 5.0 |
| Impedance | (Ω) | 50 ± 1 | | | | | | 50 ± 1 |
| Capacitance | (pF/m) | 75.8 | | | | | | 73.8 |
| Relative signal propagation | (%) | 88 | | | | | | 90.3 |
| Signal delay | (ns/m) | 3.80 | | | | | | 3.70 |
| Max. operating voltage | (kVrms) | 2.91 | | | | | | 3.00 |
| Typ. attenuation @ 1 GHz | (dB/100m) | 4.11 | | | | | | 3.76 |
| Typ. attenuation @ 2 GHz | (dB/100m) | 6.11 | | | | | | 5.53 |
| Typ. attenuation @ 2.2 GHz | (dB/100m) | 6.46 | | | | | | 5.83 |
| Max. power @ 1 GHz (40°C) | (kW) | ≤ 2.190 | | | | | | ≤ 2.260 |
| Max. power @ 2 GHz (40°C) | (kW) | ≤ 1.549 | | | | | | ≤ 1.598 |
| Max. power @ 2.2 GHz (40°C) | (kW) | ≤ 1.476 | | | | | | ≤ 1.524 |
| General data | | | | | | | | |
| Temp. range operating | (°C) | -40 / +85 | | | | | | -40 / +85 |
| Temp. range installation | (°C) | -25 / +60 | | | | | | -25 / +60 |
| Typ. weight | (kg/100m) | 59.8 | | | | | | 50.0 |
| Min. bending radius | (mm) | 120 | | | | | | 127 |

For detailed data sheets please go to www.hubersuhner.com and then search for type "SUCOFEEED".



HUBER+SUHNER SUCOFEEED CORRUGATED COAXIAL CABLES

| | SUCOFEEED_1_1/4 | | SUCOFEEED_1_1/4_FR | | SUCOFEEED_1_5/8 | | SUCOFEEED_1_5/8_FR | |
|-----------------------------|-----------------------|-----------|-----------------------------|-----------------|-----------------------|-----------------------------|-----------------------|-----------------|
| | Dimension | 1 1/4" | Dimension | 1 1/4" | Dimension | 1 5/8" | Dimension | 1 5/8" |
| Cable design | Cable group | M32 | Cable group | M32 | Cable group | M42 | Cable group | M42 |
| | Jacket version | Standard | Jacket version | Flame retardant | Jacket version | Standard | Jacket version | Flame retardant |
| Inner conductor | (∅ in mm) | 13.10 | Inner conductor | (∅ in mm) | 13.10 | Inner conductor | (∅ in mm) | 17.30 |
| Dielectric | (∅ in mm) | 32.40 | Dielectric | (∅ in mm) | 32.40 | Dielectric | (∅ in mm) | 42.80 |
| Outer conductor | (∅ in mm) | 35.80 | Outer conductor | (∅ in mm) | 35.80 | Outer conductor | (∅ in mm) | 46.40 |
| Jacket | (∅ in mm) | 39.50 | Jacket | (∅ in mm) | 39.50 | Jacket | (∅ in mm) | 49.80 |
| Electrical data | | | | | | | | |
| Typ. operating frequency | (GHz) | ≤ 3 | Typ. operating frequency | (GHz) | ≤ 3 | Typ. operating frequency | (GHz) | ≤ 2.5 |
| Impedance | (Ω) | 50 ± 1 | Impedance | (Ω) | 50 ± 1 | Impedance | (Ω) | 50 ± 1 |
| Capacitance | (pF/m) | 76.5 | Capacitance | (pF/m) | 76.5 | Capacitance | (pF/m) | 76.8 |
| Relative signal propagation | (%) | 88.0 | Relative signal propagation | (%) | 88.0 | Relative signal propagation | (%) | 87.5 |
| Signal delay | (ns/m) | 3.80 | Signal delay | (ns/m) | 3.80 | Signal delay | (ns/m) | 3.80 |
| Max. operating voltage | (kVrms) | 4.2 | Max. operating voltage | (kVrms) | 4.2 | Max. operating voltage | (kVrms) | 5.4 |
| Typ. attenuation @ 1 GHz | (dB/100m) | 2.94 | Typ. attenuation @ 1 GHz | (dB/100m) | 2.94 | Typ. attenuation @ 1 GHz | (dB/100m) | 2.43 |
| Typ. attenuation @ 2 GHz | (dB/100m) | 4.43 | Typ. attenuation @ 2 GHz | (dB/100m) | 4.43 | Typ. attenuation @ 2 GHz | (dB/100m) | 3.71 |
| Typ. attenuation @ 2.2 GHz | (dB/100m) | 4.69 | Typ. attenuation @ 2.2 GHz | (dB/100m) | 4.69 | Typ. attenuation @ 2.2 GHz | (dB/100m) | 3.94 |
| Max. power @ 1 GHz (40°C) | (kW) | ≤ 3.320 | Max. power @ 1 GHz (40°C) | (kW) | ≤ 3.320 | Max. power @ 1 GHz (40°C) | (kW) | ≤ 4.300 |
| Max. power @ 2 GHz (40°C) | (kW) | ≤ 2.348 | Max. power @ 2 GHz (40°C) | (kW) | ≤ 2.348 | Max. power @ 2 GHz (40°C) | (kW) | ≤ 3.041 |
| Max. power @ 2.2 GHz (40°C) | (kW) | ≤ 2.238 | Max. power @ 2.2 GHz (40°C) | (kW) | ≤ 2.238 | Max. power @ 2.2 GHz (40°C) | (kW) | ≤ 2.899 |
| General data | | | | | | | | |
| Temp. range operating | (°C) | -40 / +85 | Temp. range operating | (°C) | -30 / +80 | Temp. range operating | (°C) | -40 / +85 |
| Temp. range installation | (°C) | -25 / +60 | Temp. range installation | (°C) | -25 / +60 | Temp. range installation | (°C) | -25 / +60 |
| Typ. weight | (kg/100m) | 98.0 | Typ. weight | (kg/100m) | 110.0 | Typ. weight | (kg/100m) | 144.8 |
| Min. bending radius | (mm) | 200 | Min. bending radius | (mm) | 200 | Min. bending radius | (mm) | 300 |

For detailed data sheets please go to www.hubersuhner.com and then search for type "SUCOFEEED".

HUBER+SUHNER – Excellence in Connectivity Solutions

HUBER+SUHNER is a leading global supplier of components and systems for electrical and optical connectivity in communications, industrial and transportation markets. HUBER+SUHNER can draw on core competences in the

areas of high frequency technology, fibre optics, cables and polymers. Working in close collaboration with our customers around the globe, we strive for excellence in the development and manufacturing of high quality products.



HUBER+SUHNER is certified according to ISO 9001 and ISO 14001.

WAIVER

It is exclusively in written agreements that we provide our customers with warrants and representations as to the technical specifications and/or the fitness for any particular purpose. The facts and figures contained herein are carefully compiled to the best of our knowledge, but they are intended for general informational purposes only.



HUBER+SUHNER AG
 RF Technology
 CH-9100 Herisau
 Phone +41 (0)71 353 41 11
 Fax +41 (0)71 353 45 90
www.hubersuhner.com