

Series SMA

Coaxial Connectors

Edition 2011



Contents

| | |
|--|----|
| Introduction | 4 |
| Technical data | 5 |
| Straight cable plugs | 9 |
| 26.5 GHz - straight cable plugs | 13 |
| Right angle cable plugs | 14 |
| 26.5 GHz - right angle cable plugs | 17 |
| Straight cable jacks | 17 |
| Straight bulkhead cable jacks | 19 |
| 26.5 GHz - straight bulkhead cable jacks | 21 |
| Straight panel cable jacks | 21 |
| Straight bulkhead receptacles | 23 |
| Straight panel receptacles | 26 |
| Right angle panel receptacle | 29 |
| 26.5 GHz - straight panel receptacle | 30 |
| PCB connectors | 31 |
| Protective caps and shorts | 33 |
| Suitable cables | 34 |
| Mounting holes | 38 |

Series SMA, Subminiature Connectors

HUBER+SUHNER SMA connectors are precision connectors for microwave applications up to 18 GHz. The extended frequency version operates with excellent return loss performances up to 26.5 GHz. There is a huge variety of applications for HUBER+SUHNER SMA connectors, as in telecom, test+measurement, instruments, avionics, etc.

The HUBER+SUHNER series SMA is classified into two categories:

- HUBER+SUHNER Standard SMA connectors for high end applications or applications subject to rough conditions.
- HUBER+SUHNER® ECO SMA connectors for high volume applications. Besides the economic aspect, HUBER+SUHNER® ECO SMA connectors offer a compact design with a low ecological impact.

The two connector categories have different technical data and material involved and are in this way tailored to the different applications.

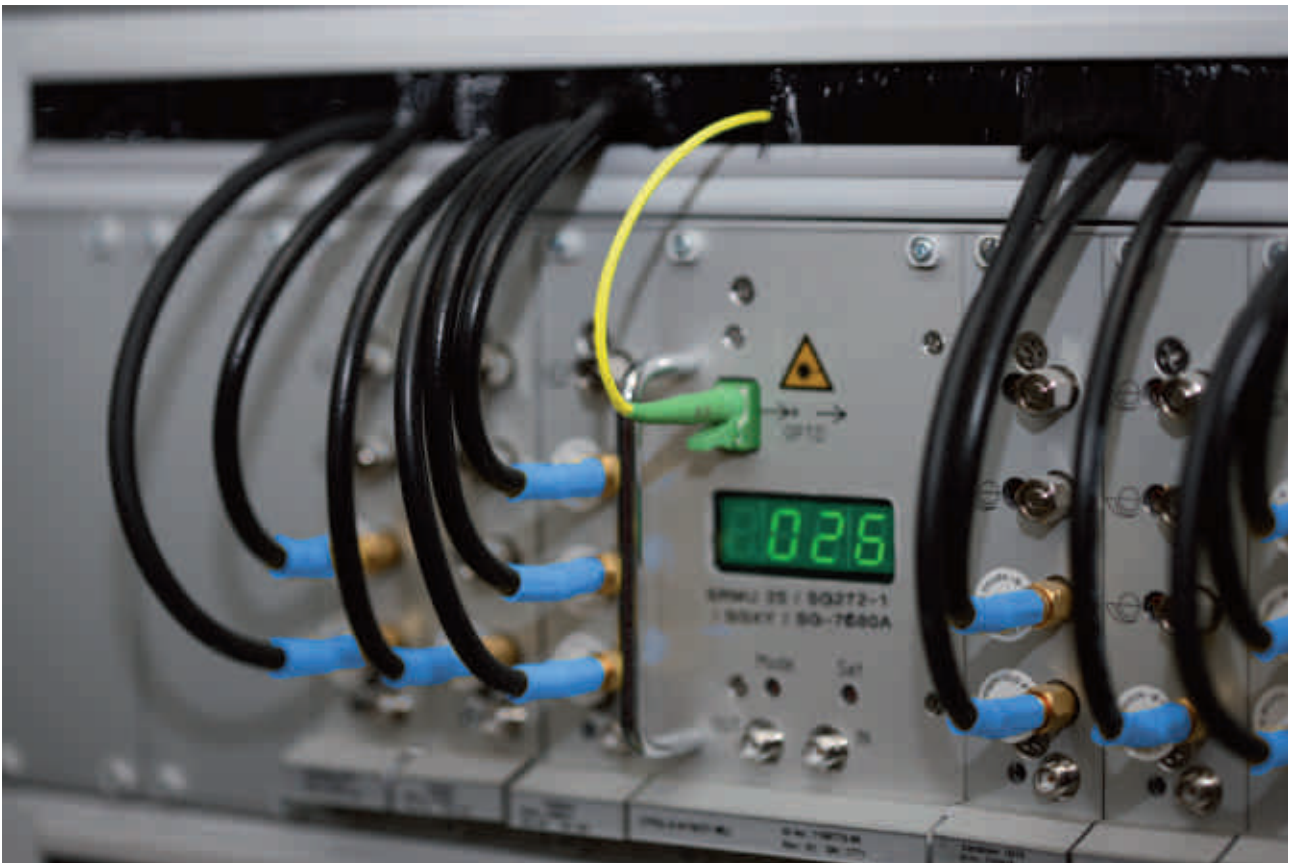

Features

- Frequency range up to 18 GHz, extended frequency version up to 26.5 GHz
- Excellent return loss
- Intermateable with PC3.5 and SK
- The SMA (Subminiature A) interface dimensions conform to the following standards:
 - International: **IEC 60169-15**
 - Europe: **CECC 22110**
 - USA: **MIL-C-39012 SMA**
Interface MIL-STD-348a/310

Benefits

- High mechanical strength
- Broadband RL performance
- Availability of hermetically sealed connectors and reverse types

Technical Data

Interface dimensions

Plug (male)

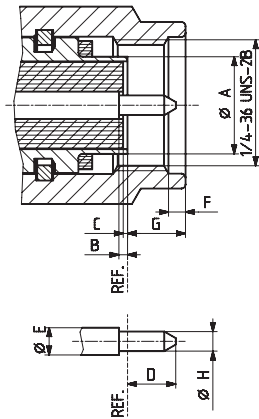

Jack (female)

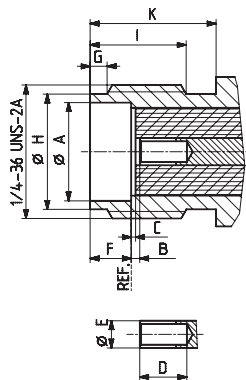

Interface dimensions (mm / inches)

| | Plug | | Jack | |
|---|-----------|-----------|-----------|-----------|
| | min. | max. | min. | max. |
| A | - | 4.59/1.81 | 4.59/.181 | - |
| B | 0.00/000 | 0.25/.010 | 0.00/000 | 0.25/.010 |
| C | 0.00/000 | 0.25/.010 | 0.00/000 | 0.25/.010 |
| C | - | 2.54/.100 | 2.67/.105 | - |
| E | 1.24/.049 | 1.29/.051 | 1.24/.049 | 1.29/.051 |
| F | 0.38/.015 | 1.14/.045 | 1.88/.074 | 1.98/.078 |
| G | - | 3.43/.135 | 0.38/.015 | 1.14/.045 |
| H | 0.90/.036 | 0.94/.037 | 5.28/.208 | 5.49/.216 |
| I | - | - | 4.32/.170 | - |
| K | - | - | 5.54/.218 | - |

IP 68 for interface in mated condition.

For IP rating of cable entry please contact our technical support.

Technical Data

| Electrical data | MIL-C-39012 | | | | |
|--|-------------|---|-------|----------|-------|
| Impedance | | 50 Ω | | | |
| Frequency range for interface | | DC ... 18 GHz (extended range DC ... 26.5 GHz) | | | |
| RL (typical value) | | for cable connectors refer to table below | | | |
| Cable type | | semi-rigid | | flexible | |
| Cable dielectric diameter (mm/in.) | | 1.5/066 | 3/117 | 1.5/066 | 3/117 |
| RF-leakage measured at 3 GHz | 3.26 | ≥ 100 dB-f (GHz) | | ≥ 60 dB | |
| Dielectric withstanding voltage (at sea level, in V rms, 50 Hz) | 3.17 | 1000 | 1500 | 750 | 1000 |
| Working voltage (at sea level, in V rms, 50 Hz) | | 335 | 500 | 250 | 335 |
| Corona extinction voltage (at 21 000 m/70 000 ft., in V rms, 50 Hz) | 3.22 | 250 | 375 | 190 | 250 |
| Working voltage (at 21 000 m/70 000 ft., in V rms, 50 Hz) | | 85 | 125 | 65 | 85 |
| RF withstanding voltage at 5 MHz (V rms) | 3.23 | 670 | 1000 | 500 | 670 |
| Insulation resistance | 3.11 | ≥ 5·10 ³ MΩ | | | |
| Contact resistance - centre contact - outer contact | 3.16 | ≤ 3 mΩ ≤ 2.5 mΩ | | | |

Typical RL for HUBER+SUHNER standard SMA cable connectors

| Typical RL (dB) | Frequency range | | | | | Cable group |
|------------------------|-----------------|---------|-------|----------|--------|-------------|
| | 1 GHz | 2.5 GHz | 5 GHz | 12.4 GHz | 18 GHz | |
| Connector type | | | | | | |
| Straight connectors | 37 | 37 | 37 | 29 | 28 | Y3, Y11 |
| | 37 | 37 | 34 | 29 | 23 | Y5, Y12 |
| | 32 | 29 | 28 | | | U2, U4 |
| | 34 | 32 | 29 | | | U7, U9 |
| Right angle connectors | 37 | 32 | 26 | 19 | | Y3, Y11 |
| | 37 | 32 | 28 | 22 | | Y5, Y12 |
| | 32 | 29 | 26 | | | U2, U4 |
| | 37 | 32 | 29 | | | U7, U9 |

Technical Data

Typical RL for HUBER+SUHNER® ECO SMA cable connectors

| Typical RL (dB) | Frequency range | | | | Cable group |
|------------------------|-----------------|---------|-------|-------|-------------|
| | 1 GHz | 2.5 GHz | 5 GHz | 6 GHz | |
| Connector type | | | | | |
| Straight connectors | 36 | 36 | 35 | 30 | Y3, Y11 |
| | 36 | 36 | 35 | 30 | Y5, Y12 |
| | 32 | 29 | 26 | 25 | U2, U4 |
| | 34 | 32 | 27 | 25 | U7, U9 |
| Right angle connectors | 36 | 32 | 26 | 25 | Y3, Y11 |
| | 36 | 32 | 28 | 24 | Y5, Y12 |
| | 32 | 29 | 26 | 25 | U2, U4 |
| | 36 | 32 | 26 | 25 | U7, U9 |

| Mechanical data | MIL-C-39012 | | |
|-------------------------------------|-------------|------------------------------|-----------------------------------|
| Recommended coupling nut torque | | HUBER+SUHNER standard SMA | 0.8 ± 1.1 Nm (7.1 ± 9.7 in. lbs.) |
| | | HUBER+SUHNER® ECO SMA | 0.45 Nm (4.0 in. lbs) |
| Coupling nut retention force | 3.25 | ≥ 270 N / 60.7 lbs | |
| Contact captivation -axial | 3.12 | HUBER+SUHNER standard SMA | ≥ 27 N / 6.1 lbs. |
| | | HUBER+SUHNER® ECO SMA | ≥ 20 N / 5.4 lbs. |
| Cable retention force ¹⁾ | | see suitable cables, page 34 | |
| Durability (matings) | | ≤ 500 | |

¹⁾ Value considers maximum load of the cables without irreversible variations of specifications.

| Environmental data | Test conditions |
|---|---|
| Temperature range | -65°C ÷ +165°C / -85 °F ÷ +329 °F |
| Climatic category | IEC → 55/155/21 |
| Thermal shock | MIL-STD-202, Method 107, Condition B |
| Moisture resistance | MIL-STD-202, Method 106 |
| Corrosion | salt spray test acc. to MIL-STD-202, Method 101, Condition B |
| Vibration | MIL-STD-202, Method 204, Condition D |
| Shock | MIL-STD-202, Method 213, Condition I |
|  | Except the hermetic sealed SMA connectors all other connector types satisfy RoHS compatibility. |

Technical Data

| Material data | | | |
|-----------------------------|---------------------------|--|----------------------|
| Connector part | | Material | Plating |
| Bodies, outer contacts, nut | HUBER+SUHNER standard SMA | copper-beryllium alloy stainless steel, spring bronze | gold, passivated |
| | HUBER+SUHNER® ECO SMA | brass, spring bronze | SUCOPLATE®, SUCOPRO® |
| Pin contacts | | copper-beryllium alloy, brass | gold, SUCOPRO® |
| Socket contacts | | copper-beryllium alloy/spring bronze | gold |
| Crimp ferrules | | copper, brass | gold |
| Insulators | | PTFE or PFA | |
| Gaskets | | silicone rubber | |

HUBER+SUHNER SMA connectors satisfy in principle the above technical data. For detailed specifications refer to the published data sheets on our webpage www.hubersuhner.com.

Straight Cable Plugs (Male)

For semi-rigid cables

- With pin and insulator
- Cable entry soldered
- Centre contact soldered

| Description | Item no. | Packaging | Cable group | Assembly instruction | Plating body | Fig. | Notes |
|------------------------------------|----------|---------------|-------------|----------------------|--------------|------|--------------------------------|
| 11_SMA-50-1-1/111_NE ¹⁾ | 22642387 | single | Y19 | 9118 | gold | 1 | |
| 11_SMA-50-1-2/111_NE ¹⁾ | 22642388 | single | Y2, Y15 | 9119 | gold | 1 | |
| 11_SMA-50-1-53/119_NH | 23013327 | bulk 100 pcs. | Y2, Y15 | 150006 | gold | 2 | nut passivated stainless steel |

1) Compound 74_Z0-0-116 needed

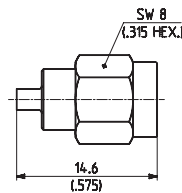

Fig. 1

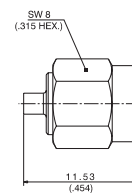

Fig. 2

| Description | Item no. | Packaging | Cable group | Assembly instruction | Plating body | Fig. | Notes |
|--------------------------------------|----------|---------------|-------------|----------------------|--------------|------|--------------------------------|
| 11_SMA-50-2-15/111_NE | 22544545 | single | Y3, Y11, | 9056 | gold | 1 | |
| 11_SMA-50-2-15/111_NH | 22645898 | bulk 100 pcs. | Y16 | | | | |
| 11_SMA-50-2-29/119_NH ¹⁾ | 22660366 | bulk 100 pcs. | Y11 | 27334 | gold | 2 | nut passivated stainless steel |
| 11_SMA-50-2-65/119_NE ¹⁾ | 22642315 | single | Y3, Y11, | 9056 | gold | 1 | nut passivated stainless steel |
| 11_SMA-50-2-65/119_NH ¹⁾ | 22645366 | bulk 100 pcs. | Y16 | | | | |
| 11_SMA-50-2-110/133_NE ²⁾ | 84130715 | single | Y3, Y11, | 0000349249 | SUCOPLATE® | 3 | |
| 11_SMA-50-2-110/133_NP ²⁾ | 84117816 | bulk 500 pcs. | Y16 | | | | |

1) Cable entry CuBe/gold

2) Use torque wrench 74_Z0-0-79

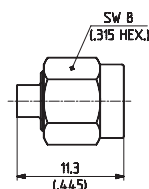

Fig. 1

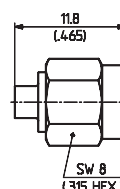

Fig. 2

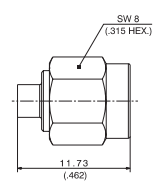

Fig. 3

All highlighted types are HUBER+SUHNER® ECO SMA types.

Cable groups see page 34 ff.

Straight Cable Plugs (Male)

For semi-rigid cables

- With pin and insulator
- Cable entry soldered
- Centre contact soldered

| Description | Item no. | Packaging | Cable group | Assembly instruction | Plating body | Fig. | Notes |
|--|----------------------|-------------------------|-----------------|----------------------|--------------|------|--------------------------------|
| 11_SMA-50-3-15/111_NE 11_SMA-50-3-15/111_NH | 22544547 22651601 | single bulk 100 pcs. | Y5, Y12, Y17 | 9056 | gold | 1 | |
| 11_SMA-50-3-65/119_NE 11_SMA-50-3-65/119_NH | 22641643 22646570 | single bulk 100 pcs. | Y5, Y12, Y17 | 9056 | gold | 1 | nut passivated stainless steel |
| 11_SMA-50-3-235/133_NE ¹⁾ 11_SMA-50-3-235/133_NP ¹⁾ | 84130698 84104274 | single bulk 500 pcs. | Y5, Y12, Y17 | 0000333508 | SUCOPLATE® | 2 | |
| 11_SMA-50-5-1/111_NE | 22642399 | single | Y7, Y13 | 0000181414 | gold | 3 | |

1) Use torque wrench 74_Z00-79

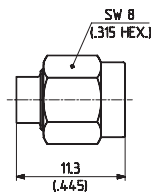

Fig. 1

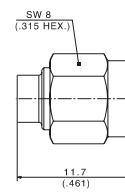

Fig. 2

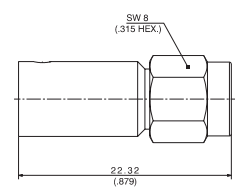

Fig. 3

Straight Cable Plugs (Male)

For flexible cables

- Cable entry clamp
- Centre contact soldered

| Description | Item no. | Packaging | Cable group | Assembly instruction | Plating body |
|-----------------------|----------|---------------|-------------|----------------------|--------------|
| 11_SMA-50-3-7/111_NE | 22640050 | single | U7 | 3071 | gold |
| 11_SMA-50-3-8/111_NH | 22648630 | bulk 100 pcs. | U9, U11 | 3071 | gold |
| 11_SMA-50-3-10/111_NE | 22640053 | single | U9, U11 | 3071 | gold |

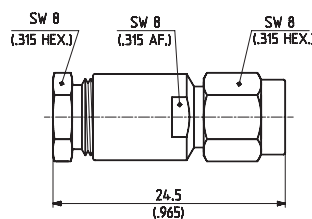

All highlighted types are HUBER+SUHNER® ECO SMA types.
Cable groups see page 34 ff.

Straight Cable Plugs (Male)

For flexible cables

- Cable entry crimp
- Centre contact soldered

| Description | Item no. | Packaging | Cable group | Assembly instruction | Plating body | Crimp insert | Fig. | Notes |
|---------------------------------------|----------|---------------|-------------|----------------------|----------------------------|--------------|------|-------------|
| 11_SMA-50-1-4/111_NE | 22645871 | single | U1 | 27061 | gold | A | 1 | |
| 11_SMA-50-1-7/111_NE | 22660329 | single | X1 | 27061 | gold | A | 2 | |
| 11_SMA-50-2-5/111_NE | 22640042 | single | U2 | 27266 | gold | A | 1 | |
| 11_SMA-50-2-5/111_NH | 22646312 | bulk 100 pcs. | | | | | | |
| 11_SMA-50-2-6/111_NE | 22640043 | single | U4 | 27266 | gold | A | 1 | |
| 11_SMA-50-2-6/111_NH | 22650740 | bulk 100 pcs. | | | | | | |
| 11_SMA-50-2-27/111_NE ¹⁾ | 84022967 | single | U2 | 27164 | gold | 1 A | 1 | |
| 11_SMA-50-2-27/111_NH ¹⁾ | 22652923 | bulk 100 pcs. | | | | | | |
| 11_SMA-50-2-55/199_NE | 22641377 | single | U2 | 3069 | passivated stainless steel | A | 1 | |
| 11_SMA-50-2-56/199_NE | 22641376 | single | U4 | 3069 | passivated stainless steel | A | 1 | |
| 11_SMA-50-2-56/199_NH | 22651486 | bulk 100 pcs. | | | | | | |
| 11_SMA-50-2-111/133_NE ²⁾ | 84130699 | single | U2 | 0000348839 | SUCOPLATE® | A | 3 | |
| 11_SMA-50-2-111/133_NP ²⁾ | 84117820 | bulk 500 pcs. | | | | | | |
| 11_SMA-50-2-112/133_NE ²⁾ | 84130700 | single | U4 | 0000347891 | SUCOPLATE® | A | 3 | |
| 11_SMA-50-2-112/133_NP ²⁾ | 84115820 | bulk 500 pcs. | | | | | | |
| 11_SMA-R50-2-113/133_NE ²⁾ | 84130701 | single | U4 | 0000360393 | SUCOPLATE® | A | 3 | reverse SMA |
| 11_SMA-R50-2-113/133_NP ²⁾ | 84117824 | bulk 500 pcs. | | | | | | |

1) HUBER+SUHNER® full crimp
 2) Use torque wrench 74_Z00-79.

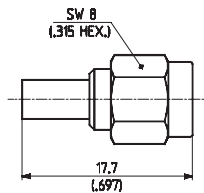

Fig. 1

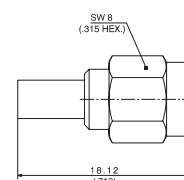

Fig. 2

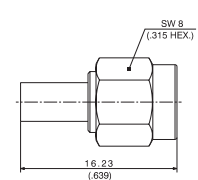

Fig. 3

All highlighted types are HUBER+SUHNER® ECO SMA types.
 Cable groups see page 34 ff.

Straight Cable Plugs (Male)

For flexible cables

- Cable entry crimp
- Centre contact soldered

| Description | Item no. | Packaging | Cable group | Assembly instruction | Plating body | Crimp insert | Fig. | Notes |
|--|----------------------|-------------------------|-----------------|----------------------|----------------------------|--------------|------|-------------|
| 11_SMA-50-3-5/111_NE 11_SMA-50-3-5/111_NH | 22640048 22644684 | single bulk 100 pcs. | U7 | 3069 | gold | B | 1 | |
| 11_SMA-50-3-6/111_NE 11_SMA-50-3-6/111_NH | 22640049 22650739 | single bulk 100 pcs. | U9, U11 | 3069 | gold | B | 1 | |
| 11_SMA-50-3-55/199_NE | 22641371 | single | U7 | 3069 | passivated stainless steel | B | 1 | |
| 11_SMA-50-3-56/199_NE 11_SMA-50-3-56/199_NH | 22543647 22648300 | single bulk 100 pcs. | U9, U11 | 3069 | passivated stainless steel | B | 1 | |
| 11_SMA-50-3-236/133_NE ¹⁾ 11_SMA-50-3-236/133_NP ¹⁾ | 84130702 84117821 | single bulk 500 pcs. | U9, U11 | 0000349507 | SUCOPLATE® | B | 2 | |
| 11_SMA-50-3-237/133_NE ¹⁾ 11_SMA-50-3-237/133_NP ¹⁾ | 84130709 84117823 | single bulk 500 pcs. | U7 | 0000349571 | SUCOPLATE® | B | 3 | |
| 11_SMA-R50-3-238/133_NE ¹⁾ 11_SMA-R50-3-238/133_NP ¹⁾ | 84130704 84117825 | single bulk 500 pcs. | U9, U11 | 0000360525 | SUCOPLATE® | B | 2 | reverse SMA |
| 11_SMA-50-4-50/133_NE ¹⁾ 11_SMA-50-4-50/133_NP ¹⁾ | 84130705 84112519 | single bulk 500 pcs. | S16, X9, X26 | 0000347768 | SUCOPLATE® | C | 4 | |

1) Use torque wrench 74_Z00-79.

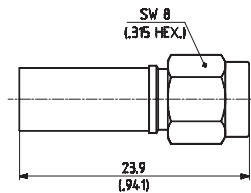

Fig. 1

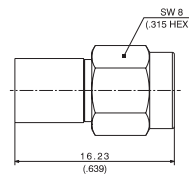

Fig. 2

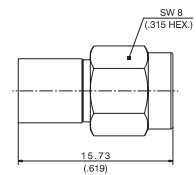

Fig. 3

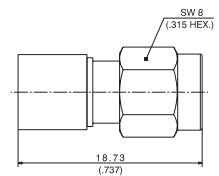

Fig. 4

All highlighted types are HUBER+SUHNER® ECO SMA types.
Cable groups see page 34 ff.

26.5 GHz – Straight Cable Plugs (Male)

For semi-rigid cables

- With pin and isolator
- Centre contact soldered

| Description | Item no. | Packaging | Cable group | Assembly instruction | Plating body |
|------------------------|----------|---------------|--------------|----------------------|--------------|
| 11_SMA-50-3-100/111_NE | 22648718 | single | Y5, Y12, Y17 | 0000181590 | gold |
| 11_SMA-50-3-100/111_NH | 22658936 | bulk 100 pcs. | | | |

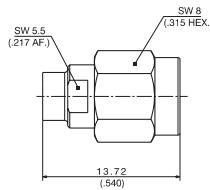
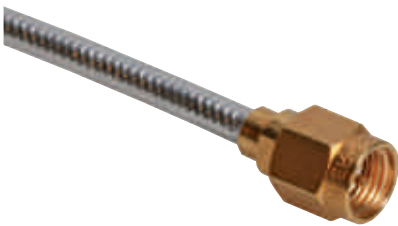

- Without pin and isolator

| Description | Item no. | Packaging | Cable group | Assembly instruction | Plating body | Fig. | Notes |
|-----------------------|----------|---------------|-------------|----------------------|--------------|------|--------------------------------|
| 11_SMA-50-3-14/-11_NH | 22644467 | bulk 100 pcs. | Y5 | 9055 | gold | 1 | |
| 11_SMA-50-3-16/-11_NH | 22644470 | bulk 100 pcs. | Y5 | 9055 | gold | 2 | |
| 11_SMA-50-3-42/-33_NE | 22649222 | single | Y5 | 9055 | SUCOPLATE® | 2 | |
| 11_SMA-50-3-42/-33_NH | 22646128 | bulk 100 pcs. | | | | | |
| 11_SMA-50-3-64/-19_NH | 22649224 | bulk 100 pcs. | Y5 | 9055 | gold | 1 | nut passivated stainless steel |
| 11_SMA-50-3-66/-19_NE | 22641644 | single | Y5 | 9055 | gold | 2 | nut passivated stainless steel |
| 11_SMA-50-3-66/-19_NH | 22645207 | bulk 100 pcs. | | | | | |

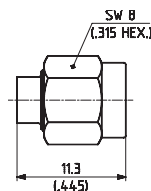

Fig. 1

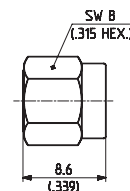

Fig. 2

Cable groups see page 34 ff.

Right Angle Cable Plugs (Male)

For semi-rigid cables

- With pin and isolator
- Centre contact soldered

| Description | Item no. | Packaging | Cable group | Assembly instruction | Plating body | Fig. | Notes |
|--|----------------------|-------------------------|-----------------|----------------------|--------------|------|--------------------------------|
| 16_SMA-50-2-53/119_NE 16_SMA-50-2-53/119_NH | 22644242 22646639 | single bulk 100 pcs. | Y3, Y11, Y16 | 3068 | gold | 1 | nut passivated stainless steel |
| 16_SMA-50-2-103/111_NE 16_SMA-50-2-103/111_NH | 84018309 22652924 | single bulk 100 pcs. | Y3, Y11, Y16 | 3068 | gold | 1 | |
| 16_SMA-50-2-110/133_NE ¹⁾ 16_SMA-50-2-110/133_NP ¹⁾ | 84130706 84117807 | single bulk 500 pcs. | Y3, Y11, Y16 | 0000335631 | SUCOPLATE® | 2 | |

1) Use torque wrench 74_Z00-79.

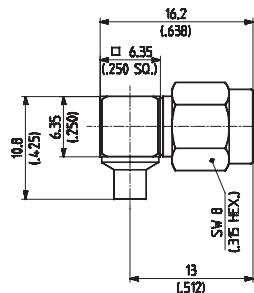

Fig. 1

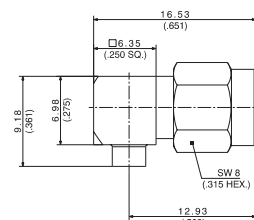

Fig. 2

- With pin and isolator
- Centre contact soldered

| Description | Item no. | Packaging | Cable group | Assembly instruction | Plating body | Fig. | Notes |
|--|----------------------|-------------------------|-----------------|----------------------|--------------|------|--------------------------------|
| 16_SMA-50-3-3/111_NE 16_SMA-50-3-3/111_NH | 22640073 22646569 | single bulk 100 pcs. | Y5, Y12, Y17 | 3068 | gold | 1 | |
| 16_SMA-50-3-13/133_NE ¹⁾ 16_SMA-50-3-13/133_NP ¹⁾ | 84130707 84117810 | single bulk 500 pcs. | Y5, Y12, Y17 | 0000335642 | SUCOPLATE® | 2 | |
| 16_SMA-50-3-53/119_NE 16_SMA-50-3-53/119_NH | 22644243 22646561 | single bulk 100 pcs. | Y5, Y12, Y17 | 3068 | gold | 1 | nut passivated stainless steel |

1) Use torque wrench 74_Z00-79.

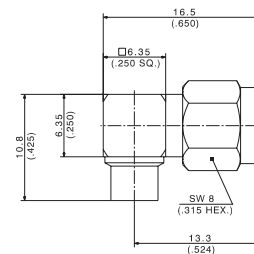

Fig. 1

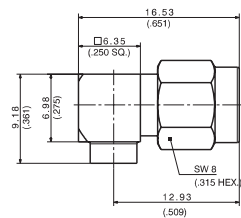

Fig. 2

All highlighted types are HUBER+SUHNER® ECO SMA types.
Cable groups see page 34 ff.

Right Angle Cable Plugs (Male)

For flexible cables

- Cable entry crimp
- Centre contact soldered

| Description | Item no. | Packaging | Cable group | Assembly instruction | Plating body | Crimp insert | Fig. | Notes |
|--|----------------------|-------------------------|-------------|----------------------|-------------------------------|--------------|------|----------------|
| 16_SMA-50-1-1/111_NE 16_SMA-50-1-1/111_NH | 22641805 22660358 | single bulk 100 pcs. | U1 | 3070 | gold | A | 1 | |
| 16_SMA-50-2-55/199_NE 16_SMA-50-2-55/199_NH | 22642661 84028953 | single bulk 100 pcs. | U2 | 3070 | passivated stainless steel | A | 2 | |
| 16_SMA-50-2-56/199_NE 16_SMA-50-2-56/199_NH | 22642662 22658888 | single bulk 100 pcs. | U4 | 3070 | passivated stainless steel | A | 2 | |
| 16_SMA-50-2-105/111_NE 16_SMA-50-2-105/111_NH | 22651455 22651456 | single bulk 100 pcs. | U2 | 3070 | gold | A | 1 | |
| 16_SMA-50-2-106/111_NE 16_SMA-50-2-106/111_NH | 22651457 22651458 | single bulk 100 pcs. | U4 | 3070 | gold | A | 1 | |
| 16_SMA-50-2-111/133_NE ¹⁾ 16_SMA-50-2-111/133_NP ¹⁾ | 84130708 84117808 | single bulk 500 pcs. | U2 | 0000335656 | SUCOPLATE® | A | 3 | |
| 16_SMA-50-2-112/133_NE ¹⁾ 16_SMA-50-2-112/133_NP ¹⁾ | 84130709 84117809 | single bulk 500 pcs. | U4 | 0000335656 | SUCOPLATE® | A | 3 | |
| 16_SMA-R50-2-113/133_NE ¹⁾ 16_SMA-R50-2-113/133_NP ¹⁾ | 84130710 84117814 | single bulk 500 pcs. | U4 | 0000368977 | SUCOPLATE® | A | 3 | reverse SMA |

1) Use torque wrench 74_Z00-79.

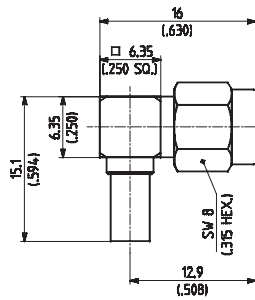

Fig. 1

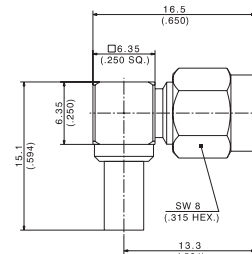

Fig. 2

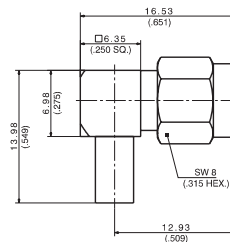

Fig. 3

All highlighted types are HUBER+SUHNER® ECO SMA types.
Cable groups see page 34 ff.

Right Angle Cable Plugs (Male)

For flexible cables

- Cable entry crimp
- Centre contact soldered

| Description | Item no. | Packaging | Cable group | Assembly instruction | Plating body | Crimp insert | Fig. | Notes |
|--|----------------------|-------------------------|-----------------|----------------------|----------------------------|--------------|------|-------------|
| 16_SMA-50-3-14/133_NE ¹⁾ 16_SMA-50-3-14/133_NP ¹⁾ | 84130711 84117811 | single bulk 500 pcs. | U9, U11 | 0000335678 | SUCOPLATE® | B | 1 | |
| 16_SMA-50-3-15/133_NE ¹⁾ 16_SMA-50-3-15/133_NP ¹⁾ | 84130712 84117812 | single bulk 500 pcs. | U7, X7 | 0000335679 | SUCOPLATE® | B | 2 | |
| 16_SMA-R50-3-16/133_NE ¹⁾ 16_SMA-R50-3-16/133_NP ¹⁾ | 84130713 84117815 | single bulk 500 pcs. | U9, U11 | 0000368978 | SUCOPLATE® | B | 1 | reverse SMA |
| 16_SMA-50-3-56/199_NE | 22642660 | single | U9, U11 | 3070 | passivated stainless steel | B | 3 | |
| 16_SMA-50-3-105/111_NE 16_SMA-50-3-105/111_NH | 22651585 22651800 | single bulk 100 pcs. | U7 | 3070 | gold | B | 4 | |
| 16_SMA-50-3-106/111_NE 16_SMA-50-3-106/111_NH | 22650546 22650545 | single bulk 100 pcs. | U9, U11 | 3070 | gold | B | 4 | |
| 16_SMA-50-4-50/133_NE ¹⁾ 16_SMA-50-4-50/133_NP ¹⁾ | 84130714 84117813 | single bulk 500 pcs. | S16, X9, X26 | 0000335684 | SUCOPLATE® | C | 5 | |

1) Use torque wrench 74_Z00-79.

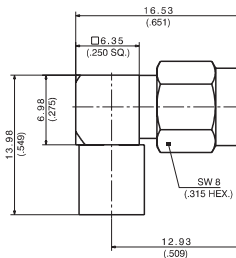

Fig. 1

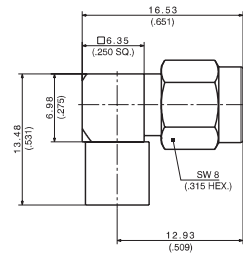

Fig. 2

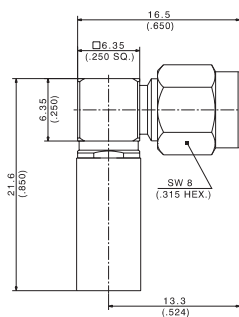

Fig. 3

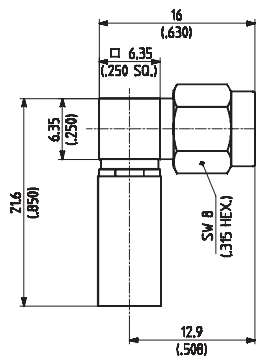

Fig. 4

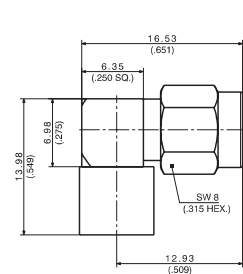

Fig. 5

All highlighted types are HUBER+SUHNER® ECO SMA types.
Cable groups see page 34 ff.

26.5 GHz – Right Angle Cable Plugs (Male)

For semi-rigid cables

- With pin and isolator
- Centre contact plugged

| Description | Item no. | Packaging | Cable group | Assembly instruction | Plating body | Fig. |
|------------------------|----------|---------------|--------------|----------------------|----------------------------|------|
| 16_SMA-50-2-100/199_NH | 23018813 | bulk 100 pcs. | Y3, Y11, Y16 | 27055 | passivated stainless steel | 1 |
| 16_SMA-50-3-100/199_NE | 22648293 | single | Y5, Y12, Y17 | 27055 | passivated stainless steel | 2 |

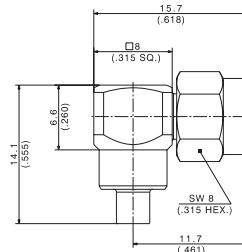

Fig. 1

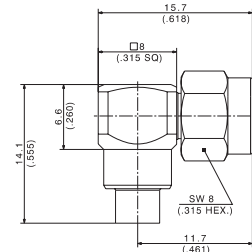

Fig. 2

Straight Cable Jacks (Female)

For semi-rigid cables

- Cable entry soldered
- Centre contact soldered

| Description | Item no. | Packaging | Cable group | Assembly instruction | Plating body | Fig. |
|-----------------------|----------|---------------|--------------|----------------------|--------------|------|
| 21_SMA-50-1-1/111_NE | 22642385 | single | Y19 | 9118 | gold | 1 |
| 21_SMA-50-1-2/111_NE | 22642386 | single | Y2, Y15 | 9119 | gold | 1 |
| 21_SMA-50-2-15/111_NE | 22544549 | single | Y3, Y11, Y16 | 9057 | gold | 2 |
| 21_SMA-50-2-15/111_NH | 22652141 | bulk 100 pcs. | | | | |
| 21_SMA-50-3-15/111_NE | 22544550 | single | Y5, Y12, Y17 | 9057 | gold | 3 |
| 21_SMA-50-3-15/111_NH | 22645042 | bulk 100 pcs. | | | | |

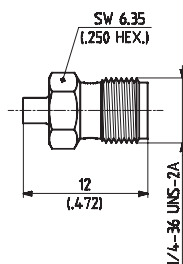

Fig. 1

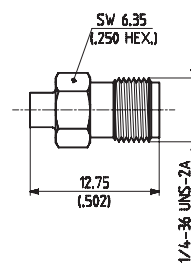

Fig. 2

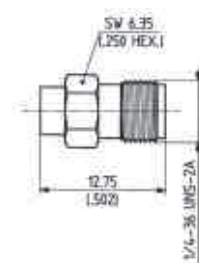

Fig. 3

Cable groups see page 34 ff.

Straight Cable Jacks (Female)

For flexible Cables

- Cable entry crimp
- Centre contact soldered

| Description | Item no. | Packaging | Cable group | Assembly instruction | Plating body | Crimp insert |
|--|----------------------|-------------------------|-------------|----------------------|--------------|--------------|
| 21_SMA-50-2-5/111_NE | 22640077 | single | U2 | 3069 | gold | A |
| 21_SMA-50-2-6/111_NE 21_SMA-50-2-6/111_NH | 22640078 22651818 | single bulk 100 pcs. | U4 | 3069 | gold | A |

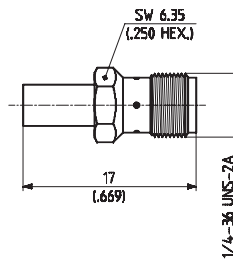

- Cable entry crimp
- Centre contact soldered

| Description | Item no. | Packaging | Cable group | Assembly instruction | Plating body | Crimp insert |
|----------------------|----------|-----------|-------------|----------------------|--------------|--------------|
| 21_SMA-50-3-5/111_NE | 22640081 | single | U7 | 3069 | gold | B |
| 21_SMA-50-3-6/111_NE | 22640082 | single | U9, U11 | 3069 | gold | B |

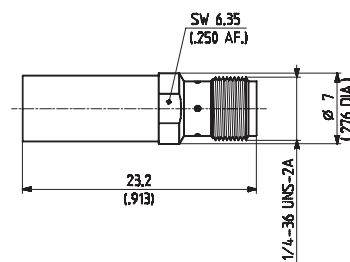

Cable groups see page 34 ff.

Straight bulkhead Cable Jacks (Female)

For semi-rigid cables

- Cable entry soldered
- Centre contact soldered
- With panel seal

| Description | Item no. | Packaging | Cable group | Assembly instruction | Plating body | Mounting hole | Fig. |
|--|----------------------|-------------------------|--------------|----------------------|--------------|---------------|------|
| 24_SMA-50-2-15/111_NE 24_SMA-50-2-15/111_NH | 22544532 22645490 | single bulk 100 pcs. | Y3, Y11, Y16 | 9057 | gold | ML 35 | 1 |
| 24_SMA-50-2-41/133_NE 24_SMA-50-2-41/133_NH | 22641381 22645368 | single bulk 100 pcs. | Y3, Y11, Y16 | 0000185051 | SUCOPLATE® | ML 20 | 2 |

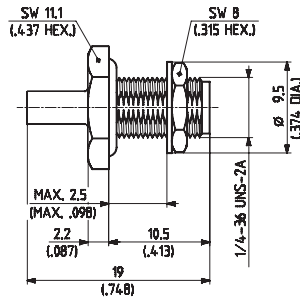

Fig. 1

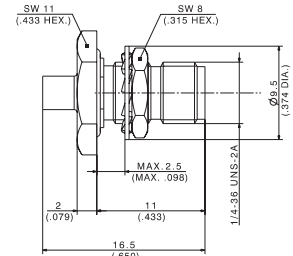

Fig. 2

- Cable entry soldered
- Centre contact soldered
- With panel seal

| Description | Item no. | Packaging | Cable group | Assembly instruction | Plating body | Mounting hole | Fig. |
|--|----------------------|-------------------------|--------------|----------------------|--------------|---------------|------|
| 24_SMA-50-3-15/111_NE 24_SMA-50-3-15/111_NH | 22641153 22645259 | single bulk 100 pcs. | Y5, Y12, Y17 | 9057 | gold | ML 35 | 1 |
| 24_SMA-50-3-17/111_NH | 23040704 | bulk 100 pcs. | Y5, Y12, Y17 | 3066 | SUCOPRO® | ML 35 | 2 |

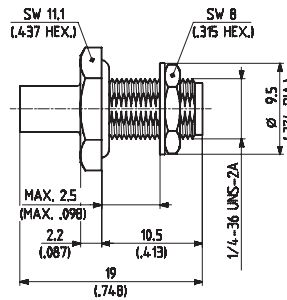

Fig. 1

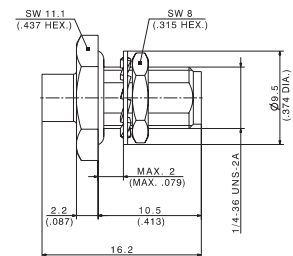

Fig. 2

All highlighted types are HUBER+SUHNER® ECO SMA types.
Cable groups see page 34 ff.
Mounting holes see page 38.

Straight bulkhead Cable Jacks (Female)

For flexible cables

- Cable entry crimp
- Centre contact soldered

| Description | Item no. | Packaging | Cable group | Assembly instruction | Plating body | Mounting hole | Crimp insert | Fig. | Notes |
|------------------------|----------|---------------|-------------|----------------------|--------------|---------------|--------------|------|-------------|
| 24_SMA-50-1-3/111_NE | 22649873 | single | U1 | 27104 | gold | ML 35 | A | 1 | |
| 24_SMA-50-2-13/111_NE | 22651767 | single | U4 | 3069 | gold | ML 20 | A | 2 | |
| 24_SMA-50-2-13/111_NH | 22651719 | bulk 100 pcs. | | | | | | | |
| 24_SMA-50-2-14/111_NE | 22651748 | single | U2 | 3069 | gold | ML 20 | A | 2 | |
| 24_SMA-50-2-14/111_NH | 22651747 | bulk 100 pcs. | | | | | | | |
| 24_SMA-50-2-45/133_NE | 22644245 | single | U4 | 3069 | SUCOPLATE® | ML 20 | A | 2 | |
| 24_SMA-50-2-45/133_NH | 22652352 | bulk 100 pcs. | | | | | | | |
| 24_SMA-50-2-46/133_NE | 22644246 | single | U2 | 3069 | SUCOPLATE® | ML 20 | A | 2 | |
| 24_SMA-50-2-46/133_NH | 22646565 | bulk 100 pcs. | | | | | | | |
| 24_SMA-R50-2-51/133_NE | 23011465 | single | U2 | 0000292354 | SUCOPLATE® | ML 35 | A | 3 | reverse SMA |
| 24_SMA-50-3-42/133_NE | 22641358 | single | U9 | 3072 | SUCOPLATE® | ML 20 | B | 4 | |

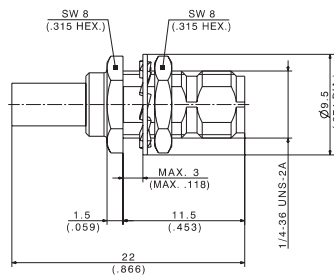

Fig. 1

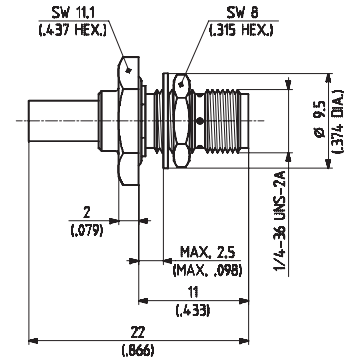

Fig. 2

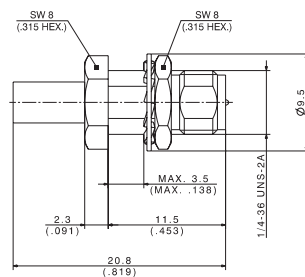

Fig. 3

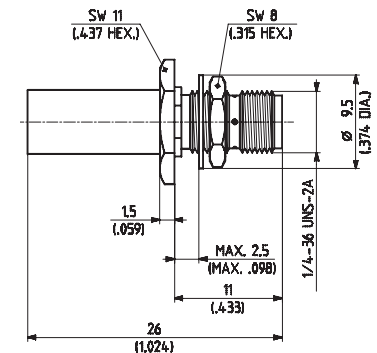

Fig. 4

All highlighted types are HUBER+SUHNER® ECO SMA types.

Cable groups see page 34 ff.

Mounting holes see page 38.

26.5 GHz – Straight bulkhead Cable Jacks (Female)

For semi-rigid cables

- Cable entry soldered
- Centre contact soldered

| Description | Item no. | Packaging | Cable group | Assembly instruction | Plating body | Mounting hole | Fig. |
|------------------------|----------|-----------|--------------|----------------------|--------------|---------------|------|
| 24_SMA-50-2-100/111_NE | 22648727 | single | Y3, Y11, Y16 | 27055 | gold | ML 35 | 1 |
| 24_SMA-50-3-100/111_NE | 22648728 | single | Y5, Y12, Y17 | 27055 | gold | ML 35 | 2 |

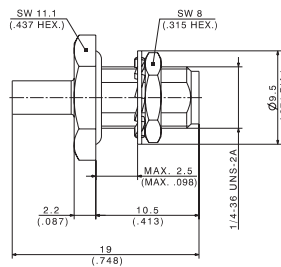

Fig. 1

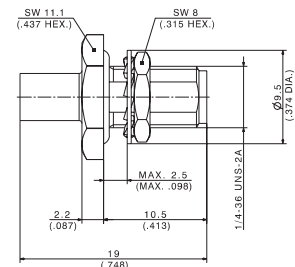

Fig. 2

Straight Panel Cable Jacks (Female)

For semi-rigid cables

- Cable entry soldered
- Centre contact soldered

| Description | Item no. | Packaging | Cable group | Assembly instruction | Plating body | Mounting hole | Fig. |
|--|----------------------|-------------------------|--------------|----------------------|--------------|---------------|------|
| 25_SMA-50-1-2/111_NE | 22642390 | single | Y2, Y15 | 9119 | gold | ML 19 | 1 |
| 25_SMA-50-1-4/111_NE 25_SMA-50-1-4/111_NH | 22642391 23017424 | single bulk 100 pcs. | Y2, Y15 | 9119 | gold | - | 2 |
| 25_SMA-50-2-15/111_NE ¹⁾ | 22544551 | single | Y3, Y11, Y16 | 9057 | gold | ML 19 | 1 |
| 25_SMA-50-2-25/111_NE ¹⁾ | 22641493 | single | Y3, Y11, Y16 | 9057 | gold | - | 2 |

1) Centre contact not captivated.

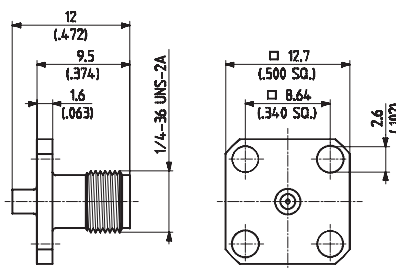

Fig. 1

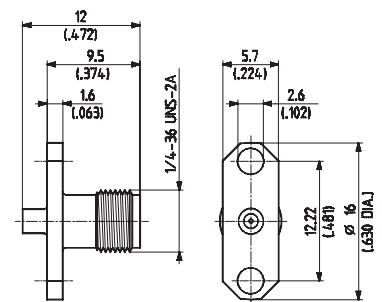

Fig. 2

Cable groups see page 34 ff.
Mounting holes see page 38.

Straight Panel Cable Jacks (Female)

For semi-rigid cables

- Cable entry soldered
- Centre contact soldered

| Description | Item no. | Packaging | Cable group | Assembly instruction | Plating body | Mounting hole | Fig. |
|-------------------------------------|----------|---------------|--------------|----------------------|--------------|---------------|------|
| 25_SMA-50-3-15/111_NE ¹⁾ | 22544552 | single | Y5, Y12, Y17 | 9057 | gold | ML 19 | 1 |
| 25_SMA-50-3-15/111_NH ¹⁾ | 22644717 | bulk 100 pcs. | | | | | |
| 25_SMA-50-3-25/111_NE ¹⁾ | 22641410 | single | Y5, Y12, Y17 | 9057 | gold | - | 2 |

1) Centre contact not captivated

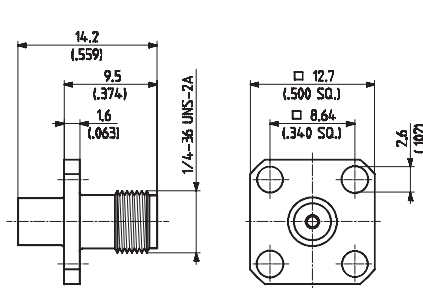

Fig. 1

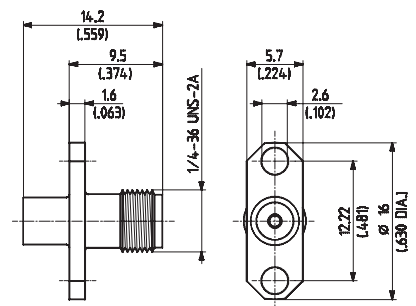
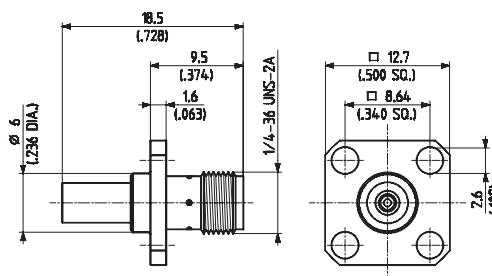

Fig. 2

- Cable entry crimp
- Centre contact soldered

| Description | Item no. | Packaging | Cable group | Assembly instruction | Plating body | Mounting hole | Crimp insert |
|-----------------------|----------|---------------|-------------|----------------------|--------------|---------------|--------------|
| 25_SMA-50-2-5/111_NE | 22640112 | single | U2 | 3072 | gold | ML 19 | A |
| 25_SMA-50-2-5/111_NH | 22650755 | bulk 100 pcs. | | | | | |
| 25_SMA-50-2-6/111_NE | 22640113 | single | U4 | 3072 | gold | ML 19 | A |
| 25_SMA-50-2-46/133_NE | 22642246 | single | U4 | 3072 | SUCOPLATE® | ML 19 | A |



All highlighted types are HUBER+SUHNER® ECO SMA types.
 Cable groups see page 34 ff.
 Mounting holes see page 38.

Straight bulkhead Receptacles

With solder end, jacks (female)

- With panel seal

| Description | Item no. | Packaging | Plating body | Mounting hole | Mounting |
|----------------------|----------|-----------|--------------|---------------|---------------|
| 22_SMA-50-0-1/111_NE | 22640087 | single | gold | ML 20 | rear mounting |

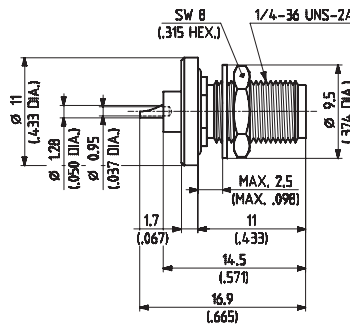

- Without panel seal

| Description | Item no. | Packaging | Plating body | Mounting hole | Mounting |
|----------------------|----------|---------------|--------------|---------------|---------------|
| 22_SMA-50-0-4/111_NE | 22640962 | single | gold | ML 35 | rear mounting |
| 22_SMA-50-0-4/111_NH | 22649418 | bulk 100 pcs. | gold | ML 35 | rear mounting |

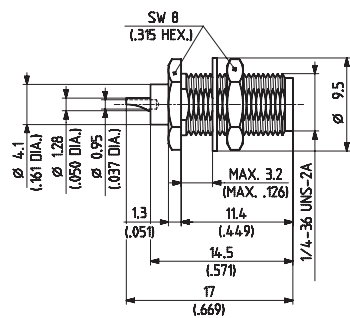

Straight bulkhead Receptacles

With coaxial end, jacks (female)

- Without panel seal

| Description | Item no. | Packaging | Plating body | Mounting hole | Mounting | Fig. |
|-------------------------------------|----------|---------------|----------------------------|---------------|----------------|------|
| 22_SMA-50-0-3/111_NE | 22640089 | single | gold | ML 98 | Front mounting | 1 |
| 22_SMA-50-0-53/199_NE | 22543498 | single | passivated stainless steel | ML 98 | Front mounting | 1 |
| 22_SMA-50-0-83/133_NH ¹⁾ | 84014290 | bulk 100 pcs. | SUCOPLATE® | ML 177 | Front mounting | 2 |

1) Use torque wrench 74_Z00-79

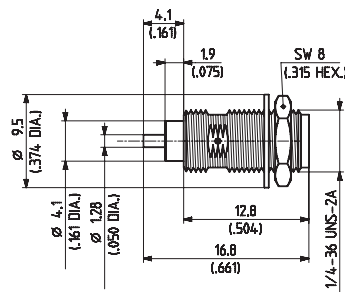

Fig. 1

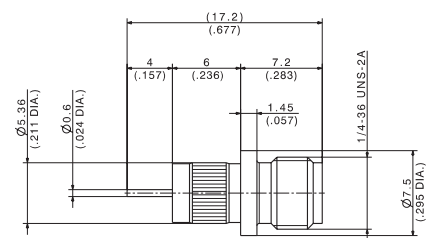

Fig. 2

Hermetically sealed, plug (male)

- «Spark Plug» with metal ring seal
- RoHs compliant alternative on request
- Front mounting

| Description | Item no. | Packaging | Plating body | Mounting hole | Notes |
|--------------------------------------|----------|-----------|--------------|---------------|-------------------------------------|
| 12_SMA-50-0-110/111_NE ¹⁾ | 22652315 | single | gold | ML 42 | leak rate 10 ⁻⁸ Torr/sec |

1) Use assembly tool 74_Z00-75 and torque wrench 74_Z00-80

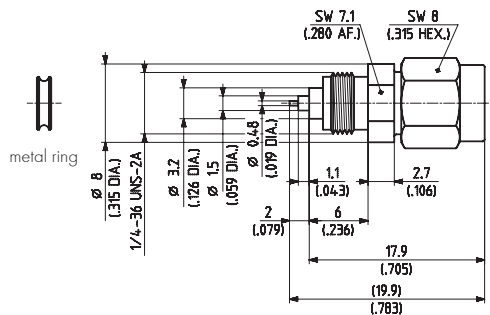

All highlighted types are HUBER+SUHNER® ECO SMA types.
Mounting holes see page 38.

Straight bulkhead Receptacles

Hermetically sealed, jacks (female)

- RoHs compliant alternative on request
- Front mounting

| Description | Item no. | Packaging | Plating body | Mounting hole | Fig. | Notes |
|--|----------------------|------------------------|--------------|---------------|------|--|
| 22_SMA-50-0-10/111_NE ¹⁾ | 22641291 | single | gold | ML 42 | 1 | «Spark Plug» with metal ring seal leak rate 10 ⁻⁸ Torr l/sec |
| 22_SMA-50-0-12/111_NE 22_SMA-50-0-12/111_NY | 84042904 22641293 | single tray 75 pcs. | gold | ML 98 | 2 | with panel seal tap drill 74_Z-0-0-24 leak rate 10 ⁻⁶ Torr l/sec |
| 22_SMA-50-0-15/111_NE | 22544588 | single | gold | ML 96 | 3 | for direct soldering ¹⁾ soldering temperature 250°C/482°F leak rate 10 ⁻⁸ Torr l/sec |

1) Use assembly tool 74_Z-0-0-75 and torque wrench 74_Z-0-0-80.



metal ring

Fig. 1

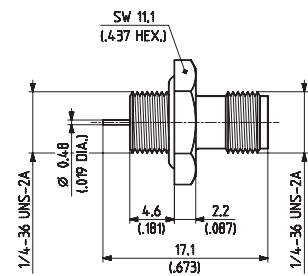
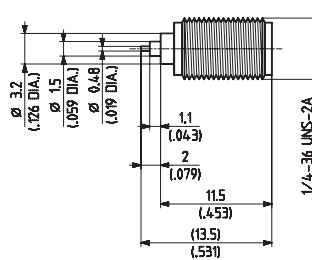

Fig. 2

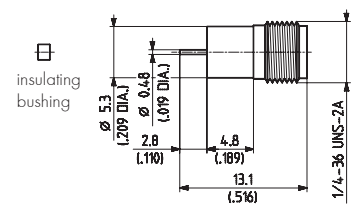

Fig. 3

insulating
bushing

Straight Panel Receptacles

With solder end, jacks (female)

| Description | Item no. | Packaging | Plating body | Notes |
|--|----------------------|-------------------------|----------------------------|------------------|
| 23_SMA-50-0-1/111_NE 23_SMA-50-0-1/111_NH | 22640090 22651409 | single bulk 100 pcs. | gold | flush dielectric |
| 23_SMA-50-0-51/199_NE | 22543948 | single | passivated stainless steel | flush dielectric |

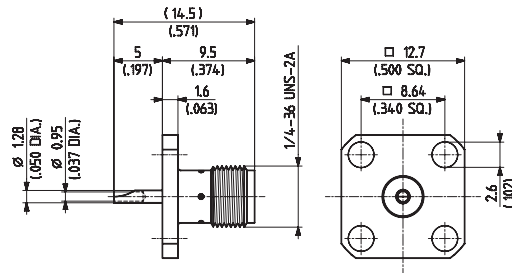

| Description | Item no. | Packaging | Plating body | Notes |
|--|----------------------|-------------------------|----------------------------|------------------|
| 23_SMA-50-0-11/111_NE | 22640095 | single | gold | flush dielectric |
| 23_SMA-50-0-41/133_NE 23_SMA-50-0-41/133_NH | 22543984 22644383 | single bulk 100 pcs. | SUCOPLATE® | flush dielectric |
| 23_SMA-50-0-61/199_NE | 22544796 | single | passivated stainless steel | flush dielectric |

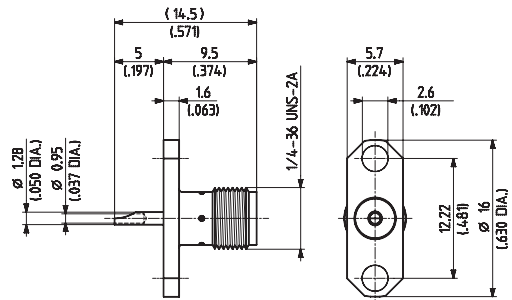

With tab end, plug (male)

| Description | Item no. | Packaging | Plating body | Notes |
|----------------------|----------|-----------|--------------|------------------|
| 13_SMA-50-0-2/111_NE | 22640056 | single | gold | flush dielectric |

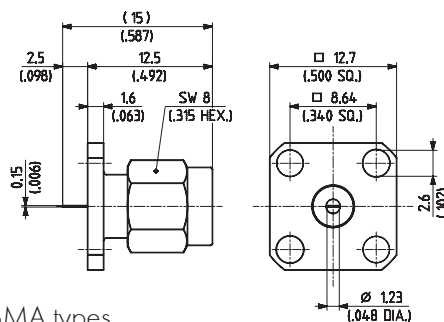

All highlighted types are HUBER+SUHNER® ECO SMA types.

Straight Panel Receptacles

With tab end, jacks (female)

| Description | Item no. | Packaging | Plating body | Notes |
|-----------------------|----------|-----------|----------------------------|------------------|
| 23_SMA-50-0-2/111_NE | 22640091 | single | gold | flush dielectric |
| 23_SMA-50-0-52/199_NE | 22543487 | single | passivated stainless steel | flush dielectric |

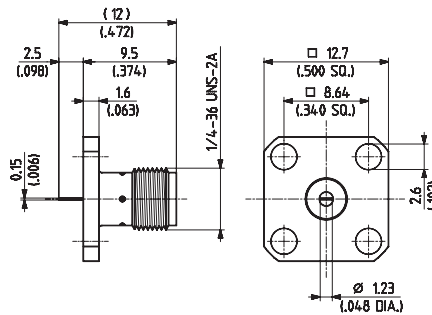

| Description | Item no. | Packaging | Plating body | Notes |
|-----------------------|----------|-----------|----------------------------|------------------|
| 23_SMA-50-0-12/111_NE | 22640096 | single | gold | flush dielectric |
| 23_SMA-50-0-62/199_NE | 22544779 | single | passivated stainless steel | flush dielectric |

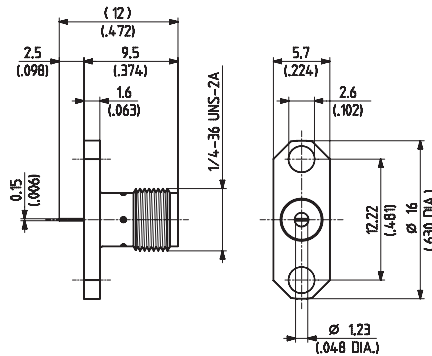

Straight Panel Receptacles

With coaxial end, jacks (female)

| Description | Item no. | Packaging | Plating body | Notes | Fig. |
|------------------------|----------|---------------|----------------------------|--|------|
| 23_SMA-50-0-3/111_NE | 22640092 | single | gold | extended dielectric | 1 |
| 23_SMA-50-0-13/111_NE | 22640097 | single | gold | extended dielectric | 2 |
| 23_SMA-50-0-13/111_NH | 22658873 | bulk 100 pcs. | gold | extended dielectric | 2 |
| 23_SMA-50-0-53/199_NE | 22641394 | single | Passivated stainless steel | extended dielectric | 1 |
| 23_SMA-50-0-53/199_NH | 22649843 | single | Passivated stainless steel | extended dielectric | 1 |
| 23_SMA-50-0-272/133_NH | 23030310 | bulk 100 pcs | SUCOPLATE® | extended dielectric | 3 |
| 23_SMA-50-0-324/111_NY | 84035778 | tray 100 pcs. | SUCOPRO® | extended dielectric with panel sealing | 4 |

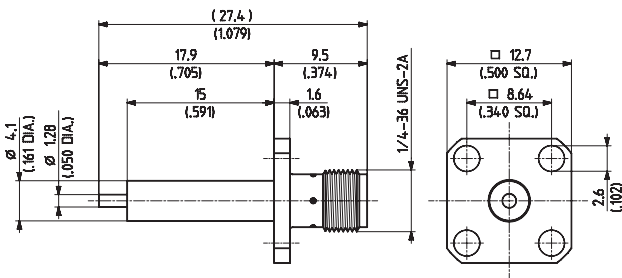

Fig. 1

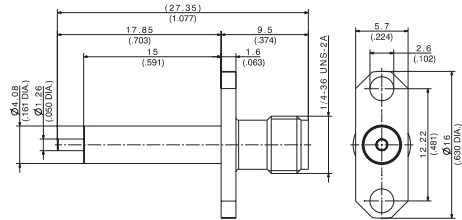

Fig. 2

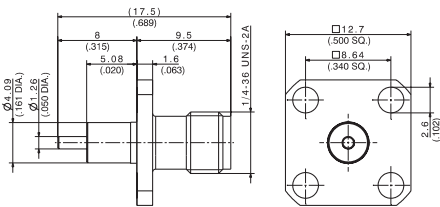

Fig. 3

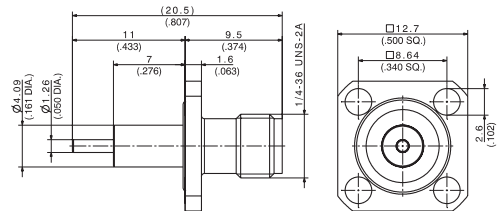

Fig. 4

All highlighted types are HUBER+SUHNER® ECO SMA types.

Straight Panel Receptacle

With coaxial end, jack (female)

| Description | Item no. | Packaging | Plating body | Notes |
|-----------------------|----------|-----------|--------------|------------------|
| 23_SMA-50-0-21/111_NE | 22640101 | single | gold | flush dielectric |

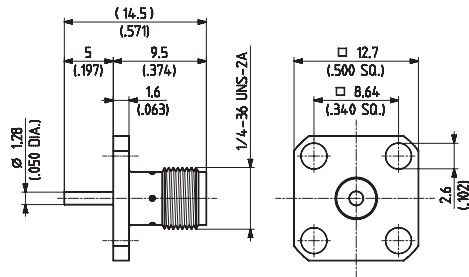

Right Angle Panel Receptacle

With solder end, jack (female)

| Description | Item no. | Packaging | Plating body | Notes |
|----------------------|----------|-----------|--------------|---------------------|
| 28_SMA-50-0-1/111_NE | 22641321 | single | gold | extended dielectric |

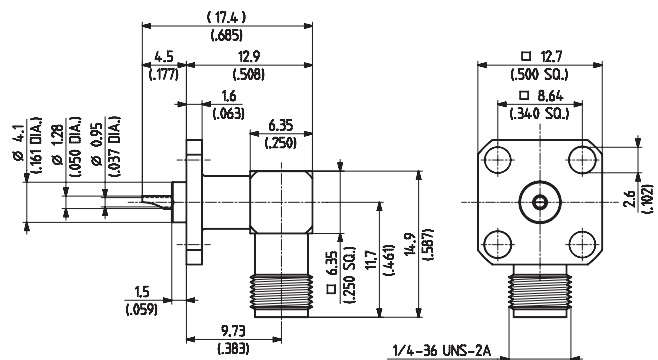
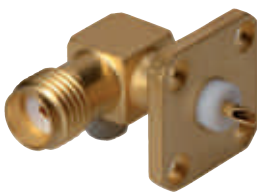

26.5 GHz - Straight Panel Receptacle

With tab end, jack (female)

| Description | Item no. | Packaging | Plating body | Mounting hole | Notes |
|-----------------------|----------|-----------|----------------------------|---------------|---------------------|
| 23_SMA-50-0-94/199_NE | 22649049 | single | passivated stainless steel | ML 93 | extended dielectric |

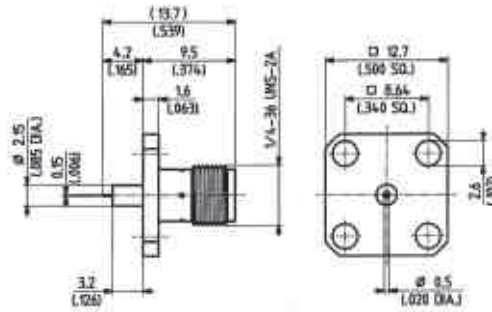

Mounting holes see page 38.

PCB Connectors

Straight PCB jacks (female)

- edge mount

| Description | Item no. | Packaging | Plating body | Mounting hole | Fig. |
|--|----------------------|--------------------------------|--------------|---------------|------|
| 82_SMA-S50-0-45/111_NE 82_SMA-S50-0-45/111_NM | 22652330 84037646 | single tape & reel 500 pcs. | SUCOPRO® | ML 132 | 1 |
| 92_SMA-50-0-10/111_NE 92_SMA-50-0-10/111_NM | 84120623 84036781 | single tape & reel 500 pcs. | SUCOPRO® | ML 132 | 2 |

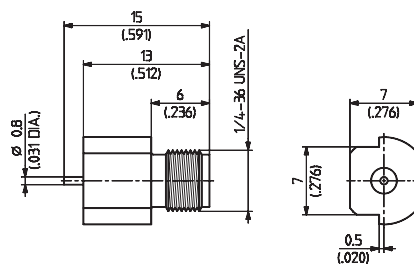

Fig. 1

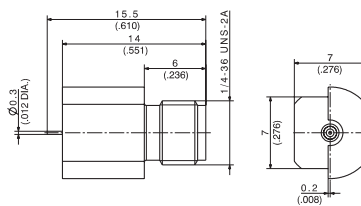
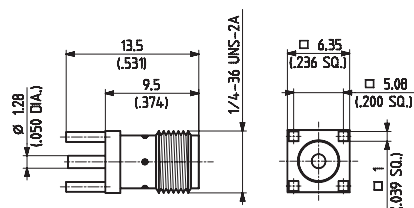

Fig. 2

Straight PCB jacks (female)

- without stand-off

| Description | Item no. | Packaging | Plating body | Mounting hole |
|--|----------------------|-------------------------|--------------|---------------|
| 82_SMA-50-0-1/111_NE 82_SMA-50-0-1/111_NH | 22543359 22644334 | single bulk 100 pcs. | gold | ML 41 |



All highlighted types are HUBER+SUHNER® ECO SMA types.
Mounting holes see page 38.

PCB Connectors

Right Angle PCB jacks (female)

- without stand-off

| Description | Item no. | Packaging | Plating body | Mounting hole |
|------------------------|----------|---------------|--------------|---------------|
| 85_SMA-50-0-101/111_NE | 22658792 | single | gold | ML 41 |
| 85_SMA-50-0-101/111_NH | 22652140 | bulk 100 pcs. | | |

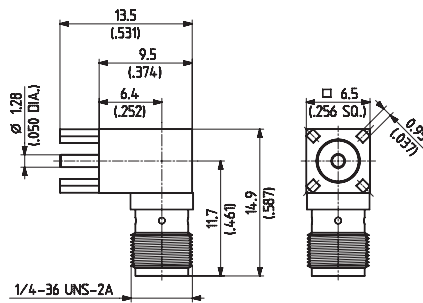

- with stand-off

| Description | Item no. | Packaging | Plating body | Mounting hole |
|------------------------|----------|---------------|--------------|---------------|
| 85_SMA-50-0-144/111_YH | 23000527 | bulk 100 pcs. | gold | ML 41 |

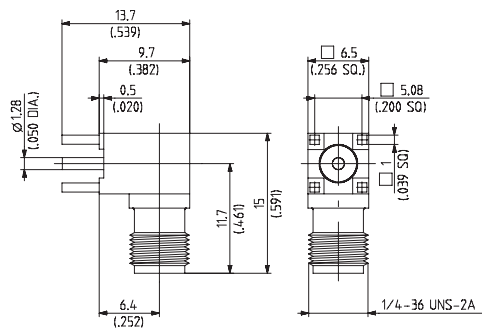

Protective Caps and Shorts

Caps for jacks

| Description | Item no. | Packaging | Plating body | Notes | Fig. |
|---------------------|----------|-----------|--------------|-----------------------------|------|
| 62_SMA-0-0-1/-11_NE | 22640159 | single | gold | humidity sealed, with chain | 1 |
| 62_SMA-0-0-8/-3_NE | 84120887 | single | SUCOPLATE® | with wire, IP 68 | 2 |

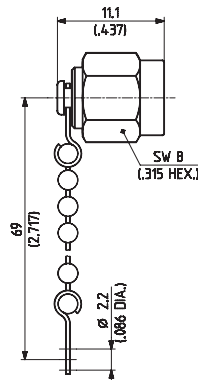

Fig. 1

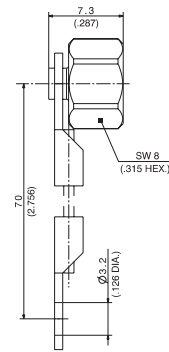
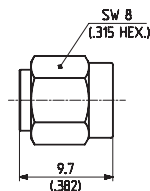

Fig. 2



Shorting cap

| Description | Item no. | Packaging | Plating body | Notes |
|----------------------|----------|-----------|--------------|-----------------|
| 64_SMA-50-0-1/111_NE | 22640161 | single | gold | humidity sealed |



All highlighted types are HUBER+SUHNER® ECO SMA types.

Suitable Cables

Flexible cables

| Screen type | Cable group | Cable type | Ω | Centre conductor | | | Insulation | |
|---------------|-------------|--|----------|--|------------------------------------|--|------------------------------|--|
| | | | | mm/inches | Material | \emptyset mm/inches | Material | \emptyset mm/inches |
| single screen | U1 | K_01232-05 RG_178_B/U EF_178 RG_196_A/U | 50 | 7x0.10/004 | CuStAg | 0.30/012 | PTFE PTFE SPEX PTFE | 0.83/033 0.83/033 082/032 0.83/033 |
| single screen | U2 | RG_174_/U RG_188A_/U RG_316_/U EF_316 | 50 | 7x 0.16/002 7x 0.18/007 0.18/007 0.18/007 | CuSt CuStAg CuStAg CuStAg | 0.48/019 0.54/021 0.54/021 0.54/021 | PE PTFE PTFE SPEX | 1.50/059 1.55/061 1.54/061 1.54/060 |
| double screen | U4 | G_02232_D K_02232_D K_02252_D EF_316_D | 50 | 7 x 0.16/006 7 x 0.18/007 7 x 0.18/007 7 x 0.18/007 | Cu CuStAg CuStAg CuStAg | 0.49/019 0.54/021 0.54/021 0.54/021 | PE PTFE PTFE SPEX | 1.50/059 1.54/061 1.54/061 1.54/061 |
| single screen | U7 | G_03232 GX_03272 RG_58_C/U RG_303_/U | 50 | 7 x 0.31/012 19 x 0.18/007 19 x 0.18/007 0.95/037 | Cu CuSn CuSn CuStAg | 0.93/037 0.90/035 0.90/035 0.95/037 | PE PEX PE PTFE | 2.95/116 |
| high screen | X7 | S_03262_B-61 SX_03272_B-60 | 50 | 1.065/042 | Cu | 1.065/042 | SPE | 2.96/116 |
| double screen | U9 | RG_142_B/U EF_142 RG_223_/U | 50 | 0.95/037 0.95/037 0.89/035 | CuStAg CuAg CuAg | 0.95/037 0.95/037 0.89/035 | PTFE SPEX PE | 2.95/116 |
| high screen | X9 | S_04162_B S_04272_B S_04212_B SX_04172_B-60 | 50 | 1.40/055 | Cu CuAg CuAg CuAg | 1.40/055 | SPE | 3.82/15 |
| double screen | U11 | RG_400_/U EF_400 | 50 | 19 x 0.19/008 | CuAg | 1.00/039 | PTFE SPEX | 2.95/116 3.03/119 |
| double screen | S16 | S_04262_D | 50 | 1.40/055 | CuAG | 1.40/055 | SPE | 3.78/148 |
| double screen | X26 | S_04262_D-09 SX_04272_D-02 | 50 | 1.40/055 | CuAg | 1.40/055 | SPE | 3.82/15 |

| Screen | | Jacket | | Cable retention force | Recommended operating frequency range | Notes |
|--|---------------------|----------|-------------|-----------------------|---------------------------------------|--------------------------|
| Material | Ø mm/inches | Material | Ø mm/inches | N/lbs. | | |
| CuAg | 1.30/0.51 | PVC | 1.80/071 | 32.7/7.3 | 1 GHz | |
| | 1.33/052 | FEP | 1.80/071 | | | |
| | 1.35/0.53 | RADOX® | 1.84/072 | | | |
| | 1.33/052 | PFA | 1.83/072 | | | |
| CuSn | 2.00/079 | PVC | 2.55/100 | 43.5/9.7 | 1 GHz | |
| CuAg | 2.00/079 | PFA | 2.60/102 | 54.4/12.1 | | |
| CuAg | 2.00/079 | FEP | 2.50/098 | 54.4/12.1 | | |
| CuAg | 2.05/080 | RADOX® | 2.52/099 | 54.4/12.1 | | |
| Cu/Cu CuAg/CuAg CuAg/CuAg CuAg/CuAg | 2.0-2.5/.08-.10 | PVC | 3.10/122 | 119.7/26.7 | 5 GHz | equivalent cable: RD 316 |
| | | UL-PVC | 3.00/118 | 108.8/24.3 | | |
| | | FEP | 3.00/118 | 108.8/24.3 | | |
| | | RADOX® | 3.10/122 | 108.8/24.3 | | |
| Cu CuAg CuSn CuAg | 3.60/.142 | PVC | 5.00/197 | 128.7/28.7 | 1 GHz | |
| | | RADOX® | 4.95/195 | | | |
| | | PVC | 4.95/195 | | | |
| | | FEP | 4.30/169 | | | |
| Al/Cu Al/CuSn | 3.20-3.80/.126-.15 | LSFH™ | 4.50/.177 | 153/34.4 | 5 GHz | |
| | | RADOX® | | 115/25.8 | | |
| CuAg/CuAg | 3.6-4.25/.142-.167 | FEP | 4.95/195 | 257.5/57.5 | 5 GHz | |
| | 3.54-4.20/.139-.165 | RADOX® | 4.95/195 | | | |
| | 3.6-4.20/.142-.165 | PVC | 5.40/213 | | | |
| Al/Cu Al/CuSn Al/CuSn Al/CuSn | 3.96-4.48/.156-.176 | LSFH™ | 5.50/216 | 130/29.2 | 6 GHz | |
| | 3.96-4.48/.156-.176 | PE | 5.50/216 | 130/29.2 | 18 GHz | |
| | 3.96-4.48/.156-.176 | PUR | 5.30/20 | 130/29.2 | 18 GHz | |
| | 4.0-4.53/.157-.178 | RADOX® | 5.50/216 | 128/28.8 | 6 GHz | |
| CuAg/CuAg | 3.6-4.20/.142-.165 | FEP | 4.95/195 | 257.5/57.5 | 5 GHz | |
| | 3.6-4.15/.142-.163 | RADOX® | 5.10/200 | | | |
| CuAg/CuAg | 4.2-4.7/.165-.185 | LSFH™ | 5.70/224 | 228.5/51.3 | 5 GHz | |
| CuAg/CuAg | 4.2-4.7/.165-.185 | LSFH™ | 5.70/224 | 247/55.5 | 6 GHz | |
| | | RADOX® | | 283/63.6 | | |

Semi-rigid cables

| Screen type | Cable group | Cable type | Centre conductor | | | Insulation | |
|------------------|-------------|-----------------|------------------|----------|-------------------------|------------|-------------------------|
| | | | Ω | Material | \varnothing mm/inches | Material | \varnothing mm/inches |
| tin soaked braid | Y2 | SUCOFORM_47_Cu | 50 | CuAg | 0.31/.012 | PTFE | 0.94/.037 |
| solid tube | Y3 | EZ_86 | 50 | CuStAg | 0.51/.020 | PTFE | 1.68/.066 |
| solid tube | Y5 | EZ_141 | 50 | CuStAg | 0.92/.036 | PTFE | 2.98/.117 |
| solid tube | Y7 | EZ_250 | 50 | CuAg | 1.63/.064 | PTFE | |
| wrap type | Y11 | MULTIFLEX_86 | 50 | CuAg | 0.47/.019 | PTFE | 1.48/.058 |
| tin soaked braid | Y12 | SUCOFORM_141 | 50 | CuStAg | 0.95/.037 | PTFE | 2.95/.116 |
| tin soaked braid | Y14 | SUCOFORM_250-01 | 50 | CuAg | 1.67/.066 | PTFE | 5.24/.206 |
| solid tube | Y15 | EZ_47 | 50 | CuStAg | 0.29/.011 | PTFE | 0.93/.037 |
| tin soaked braid | Y16 | SUCOFORM_86 | 50 | CuStAg | 0.53/.021 | PTFE | 1.65/.065 |
| wrap type | Y17 | MULTIFLEX_141 | 50 | CuAg | 0.92/.036 | PTFE | 2.93/.115 |
| solid tube | Y19 | EZ_34 | 50 | StCuAg | 0.20/.008 | PTFE | 0.66/.026 |

| Screen | | Jacket | | Cable retention force | Max. operating frequency range |
|----------|-------------|----------|-------------|-----------------------|--------------------------------|
| Material | Ø mm/inches | Material | Ø mm/inches | N/lbs. | |
| CuSn | 1.19/.047 | | | 26.1/5.87 | 40 GHz |
| Cu | 2.20/.086 | | | 158.5/35.6 | 40 GHz |
| Cu | 3.58/.141 | | | 309.1/69.5 | 33 GHz |
| Cu | 6.35/.250 | | | 952.4/212.7 | 18 GHz |
| CuAg | 2.11/.083 | FEP | 2.65/.104 | 160.0/36.0 | 40 GHz |
| CuSn | 3.58/.141 | | | 100.0/22.5 | 33 GHz |
| CuSn | 6.30/.248 | | | 100.0/22.5 | 18 GHz |
| Cu | 1.19/.047 | | | 41.8/9.3 | 107 GHz |
| CuSn | 2.20/.086 | | | 100.0/22.5 | 40 GHz |
| CuAg | 3.53/.139 | FEP | 4.14/.163 | 160.0/36.0 | 33 GHz |
| Cu | 0.86-.034 | | | 23.9/5.3 | 148 GHz |

Dimensions of Mounting Holes (ML)

| | | | |
|--------------|---------------|---------------|--------------|
| <p>ML 19</p> | <p>ML 20</p> | <p>ML 35</p> | <p>ML 41</p> |
| <p>ML 42</p> | <p>ML 93</p> | <p>ML 96</p> | <p>ML 96</p> |
| <p>ML 98</p> | <p>ML 132</p> | <p>ML 177</p> | |

FURTHER CATALOGUES



RF Coaxial Connectors

Item Nr. 644802



Microwave Cables and Assemblies

Item no. 23012500



40 Gbps Multicoax Solution MXP

Item no. 84104394

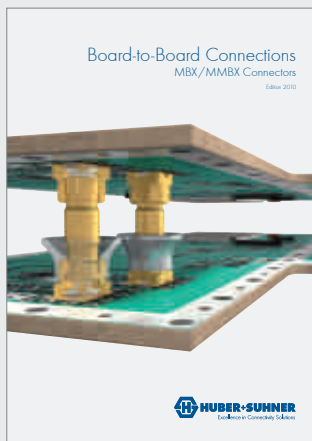

Board-to-Board Connections MBX/MMBX Connectors

Item no. 84104321

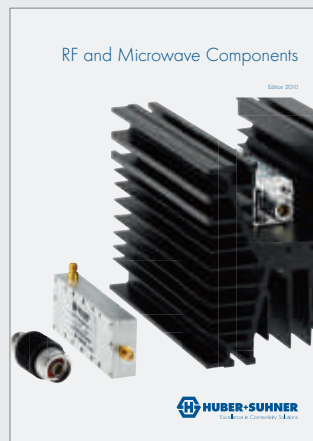

RF and Microwave Components

Item no. 84068668



Test+Measurement Components

Item no. 84068138

HUBER+SUHNER is certified according to
ISO 9001, ISO 14001, ISO/TS 16949 and IRIS.

WAIVER

It is exclusively in written agreements that we provide our customers with warrants and representations as to the technical specifications and/or the fitness for any particular purpose. The facts and figures contained herein are carefully compiled to the best of our knowledge, but they are intended for general informational purposes only.

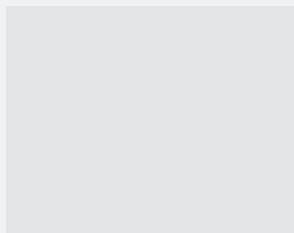

HUBER+SUHNER AG
Radio Frequency Division
Degersheimerstrasse 14
9100 Herisau
Switzerland
Tel. +41 71 353 4111
Fax +41 71 353 4444
info@hubersuhner.com

84113521/06.2011



hubersuhner.com

